



TAYLOR'S
UNIVERSITY
Wisdom • Integrity • Excellence

Welcome to

Taylor's Digital Prospectus



TAYLOR'S UNIVERSITY

RISE WITH THE BEST AND GRADUATE IN DEMAND

Since its inception in 1969, Taylor's has continuously provided excellent services for its students in terms of diverse study options, relevant curriculum and teaching methods, ongoing partnerships with leading universities worldwide, strong industry linkages, up-to-date facilities and well-equipped campuses.

Taylor's University nurtures its students in the three aspects of intelligence: intellect, practical wisdom, and craft through its Taylor'sphere ecosystem of flexible curriculum, innovative pedagogy, multidisciplinary projects, impact-based research, as well as networks with peers and alumni.



ACHIEVEMENTS

OUR AWARDS VALIDATE OUR WORLD-CLASS GRADUATES, STANDARDS & FACILITIES

WORLD
TOP 1%

UNIVERSITIES
#251



TOP 40

IN ASIA



NO. 1

PRIVATE UNIVERSITY
IN SOUTHEAST ASIA
5 YEARS IN A ROW



WORLD
TOP 20

FOR GRADUATE
EMPLOYABILITY RATE



VICE-CHANCELLOR & PRESIDENT'S MESSAGE

Taylor's University is a reputable and leading private education institution in Malaysia. With more than 50 years of experience in the education scene, we remain steadfast in fostering excellence in education, innovation, and the holistic development of our students. We infuse our research, education, and advocacy with purpose and meaning to empower our community in pursuing their passion and purpose, thus leaving a positive impact to their surrounding community.

Our prime location exposes our diverse student body from almost 100 countries to the nation's rich cultural landscape and attracts the brightest and most creative students from around the world. Our students come together to create a vibrant and exciting community that supports a wide range of sporting, cultural and leisure activities, which have become the hallmark of the Taylor's experience – cultivating a positive campus environment.

We hope that Taylor's University will be your higher education institution of choice as we remain committed in our stance as a leading institution that is equipped to empower its students to address the challenges of the modern world. Most importantly, let us work together driven by the limitless potential within our community to ensure that when you graduate, you are ready to create your own pathway to excellence and become a productive leader of change.

We look forward to seeing you at Taylor's Lakeside Campus.

Warmest Regards,
Professor Barry Winn
Vice Chancellor and President,
Taylor's University



GLOBAL RANKED SUBJECTS

TOP 20

#20
Hospitality & Leisure
Management

TOP 50

#21-50
History of Art

TOP 100

#51-100
Art & Design

Marketing

Data Science & AI

TOP 150

#101-150
Architecture
& Built Environment

Accounting & Finance

Business & Management
Studies

Social Sciences
& Management

Arts & Humanities

TOP 250

#151-200
Economics & Econometrics

Pharmacy & Pharmacology

#201-250
Computer Science
& Information Systems

Communication
& Media Studies

TOP 400

#251-300
Education & Training

#301-375
Sociology

#351-400
Electrical & Electronics
Engineering

TOP 500

#401-450
Engineering & Technology

#451-500
Medicine

TOP 600

#501-575
Mechanical Engineering



TAYLOR'S
UNIVERSITY

Wisdom • Integrity • Excellence

ARCHITECTURE BUILDING & DESIGN

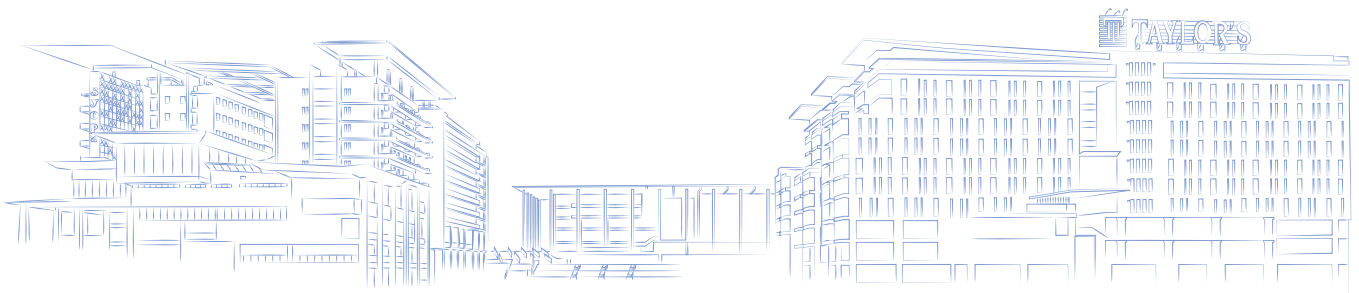

TAYLOR'sphere™

TAYLOR'S SCHOOL OF ARCHITECTURE, BUILDING & DESIGN

**WORLD
TOP 150**

**#1 PRIVATE UNIVERSITY
IN MALAYSIA**

Architecture & Built Environment



Bachelor of Quantity Surveying (Honours)
Bachelor of Science (Honours) in Architecture
Bachelor of Arts (Honours) in Interior Architecture
Bachelor of Science (Honours) in Sustainable Digital Construction Management
Master of Architecture
Master of Science in Virtual Design and Construction
Doctor of Philosophy in Architecture



CHART YOUR EDUCATION PATH

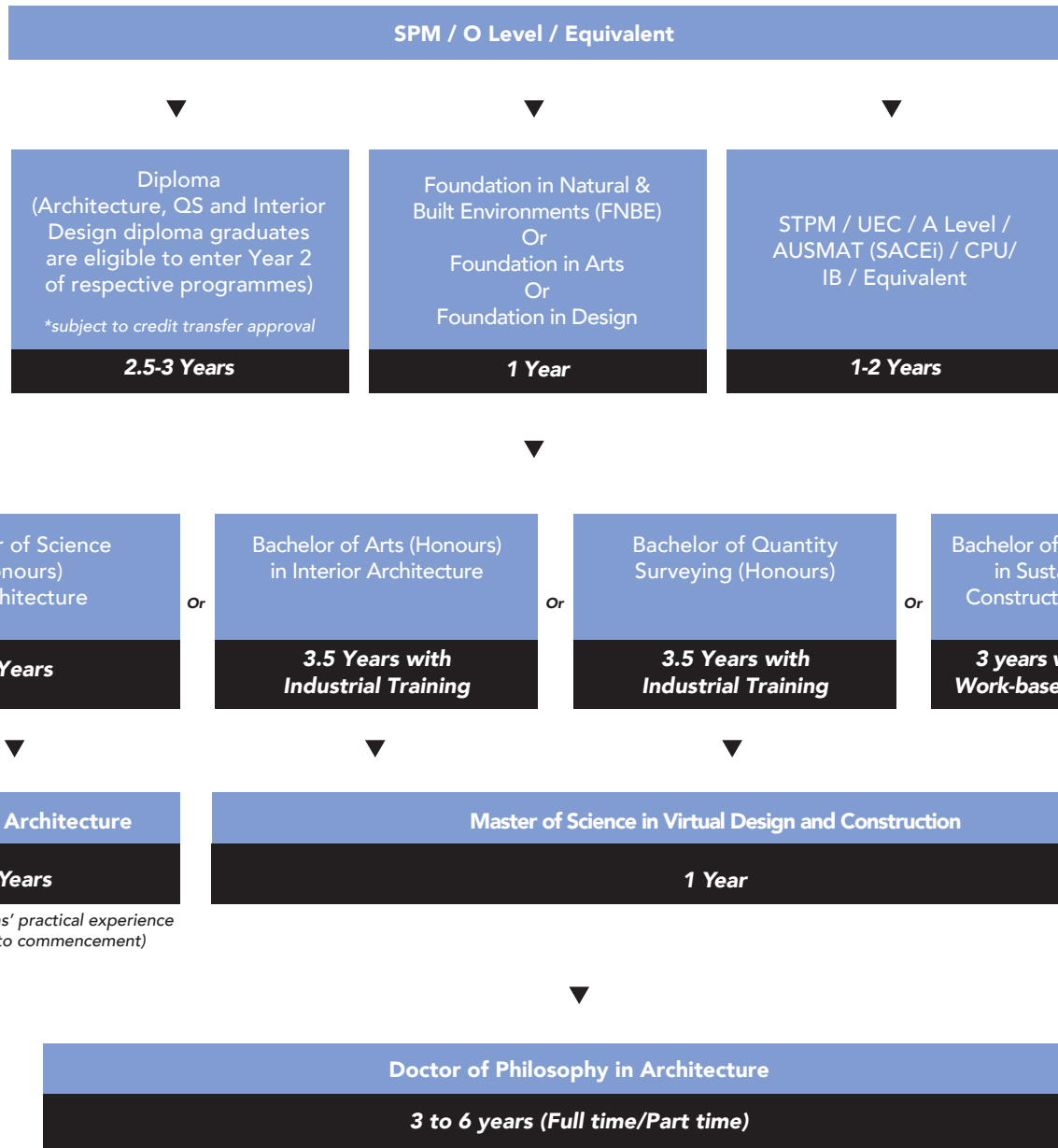

INDUSTRY-DESIGNED PROGRAMMES

The School's Industry Advisory Panel (IAP) consists of leading professionals and industry experts. They work closely with our faculty to review and refine our curriculum, ensuring that our programme content is up to date with current industry practices and requirements. These mutually beneficial partnerships also connect students to industry placements and career opportunities, ensuring that our graduates are industry-ready and future-proof.

MASTER OF ARCHITECTURE & BACHELOR OF SCIENCE (HONOURS) IN ARCHITECTURE

archicentre⁺



NGIOM PARTNERSHIP

K P SEE ARCHITECT

VERITAS

BACHELOR OF QUANTITY SURVEYING (HONOURS)



SANG
QS CONSULT

BACHELOR OF ARTS (HONOURS) IN INTERIOR ARCHITECTURE



BACHELOR OF SCIENCE (HONOURS) IN SUSTAINABLE DIGITAL CONSTRUCTION MANAGEMENT

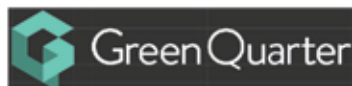

REAL-WORLD EXPERIENCE

Enhance your employability and graduate in demand by gaining hands-on learning and a sense of working in real-world environments. Internship opportunities build your experience through actual client projects at innovative and top-notch companies, while Social Innovation Projects enable collaboration with peers from multi-disciplines to create change for society.



UNLOCK MEANINGFUL CAREER OPPORTUNITIES

BACHELOR OF QUANTITY SURVEYING (HONOURS)

- Building Surveyor
- Construction Manager
- Consultant Quantity Surveyor
- Contractor Quantity Surveyor
- Developer Quantity Surveyor
- Geomatic & Land Surveyor
- Mechanical & Electrical Quantity Surveyor
- Property Management, Valuation & Estate Agency Surveyor
- Procurement Manager
- Arbitrator/ Mediator/ Litigator
- Project Manager
- BIM Expert

BACHELOR OF SCIENCE (HONOURS) IN ARCHITECTURE

- Architectural Model Specialist
- Architectural Photographer
- Architectural Structure Specialist
- Assistant Architect
- Computer-Aided Design / 3D Visualiser
- Interior Designer / Interior Architect
- Resort / Hotel Architectural Conceptualiser
- Theme Park Conceptual Architect
- Town Planning Conceptual Architect

BACHELOR OF SCIENCE (HONOURS) IN SUSTAINABLE DIGITAL CONSTRUCTION MANAGEMENT

- Construction Manager
- Green Building Consultant
- Sustainability Consultant
- Sustainability Manager
- Sustainability Analyst
- Green Building Project Manager
- Sustainability Program Specialist
- Sustainability Coordinator
- Building Information Modeling (BIM) Manager
- Smart Technologist
- Building Information Modeling (BIM) Technician
- Technical Coordinator
- Information Manager
- Digital Project Manager
- Digital Technology Project Manager

BACHELOR OF ARTS (HONOURS) IN INTERIOR ARCHITECTURE

Specialisation Areas:

- Commercial Design
- Entertainment Design
- Hospitality Design
- Institutional Design
- Recreational Design
- Residential Design

Focus Areas

- Assistant Interior Designer
- Conceptual Designer
- 3D Visualiser
- Furniture Design
- In-House Designer
- Researcher or Academician
- Set Designer
- Site Supervisor

MASTER OF ARCHITECTURE

- Architect
- Architectural Structure Specialist
- Design Consultant
- Interior Designer / Interior Architect
- Project Manager
- Site Supervisor
- Residential / Commercial Architect
- Resort / Hotel Architectural Conceptualiser
- Theme Park Conceptual Architect
- Town Planning Conceptual Architect

MASTER OF SCIENCE IN VIRTUAL DESIGN AND CONSTRUCTION

- Virtual Design and Construction (VDC) Manager
- BIM Project Manager
- BIM Manager
- BIM Designer/Coordinator
- BIM/VDC Specialist
- Digital Construction Manager/Specialist
- Project Coordinator
- VDC/BIM Specialist
- Registered Construction Project Manager

OVERSEAS EXPERIENCE VIA OUR PARTNERS*



AUSTRALIA

SWINBURNE UNIVERSITY OF TECHNOLOGY, AUS

- Bachelor of Design (Interior Architecture) (Hons)

UNIVERSITY OF SOUTH AUSTRALIA, AUS

- Bachelor of Interior Architecture



UNITED KINGDOM

Via Bachelors of Arts (Honours) in Interior Architecture

MIDDLESEX UNIVERSITY LONDON

- BA (Hons) Interior Architecture
- BA (Hons) Interior Design

Via Bachelor of Science (Honours) in Architecture

UNIVERSITY OF STRATHCLYDE

- MArch / PGDip Architectural Design (International)
- MSc Architectural Design for the Conservation of Built Heritage
- MSc Urban Design
- MSc Sustainable Engineering: Advanced Construction Technologies and BIM
- BSc (Hons) Architectural Studies / MArch Advanced Architectural Design/ MArch Architectural Design (International)
- BSc Architectural Studies

UNIVERSITY OF DUNDEE

- MArch (Hons) Architecture RIBA Part 2
- MArch (Hons) Architecture with Urban Planning RIBA Part 2

UNIVERSITY OF LIVERPOOL

- BA (Hons) in Architecture

UNIVERSITY OF PLYMOUTH

- BA Architecture
- MArch Architecture

CARDIFF UNIVERSITY

- BSc Architectural Studies

Via Bachelor of Quantity Surveying (Hons)

UWE BRISTOL, UK

- BSc (Hons) Quantity Surveying & Commercial Management
- BA (Hons) Interior Architecture

NOTTINGHAM TRENT UNIVERSITY

- BSc (Hons) Quantity Surveying and Commercial Management

*Admission is subject to the transfer requirement established by the respective universities

WHY ARCHITECTURE, BUILDING & DESIGN AT TAYLOR'S?

Taylor'sphere, our balanced ecosystem of community, facilities and features, is focused on equipping students with intellect, creativity and practical wisdom to graduate in demand for the ever-evolving landscape. Your journey in architecture, building & design studies as a Taylorian will be immersed within this ecosystem that will empower your aspirations and enable you to rise with the best, where our community is our strength.





YOUR FUTURE IS OUR PRIORITY

Strongly anchored in the philosophies of sustainable design and a people-centred approach, we ensure that our graduates are in touch with current trends and well-equipped to embrace the challenges of the 4IR.



MULTIDISCIPLINARY LEARNING EXPERIENCE (MLE)

Taylor's was one of the pioneer institutions in the region to implement compulsory multidisciplinary projects across all its undergraduate programmes. Multidisciplinary solutions go beyond just collaborating, but rather having a good understanding of learning necessities across various disciplines against being discipline-specific which will no longer be enough



PUSHING BOUNDARIES

We endeavour to instil a desire to continuously improve the quality of the environment for individuals and the community at large, by challenging our students to not just 'think out-of-the-box' but to create their own box and break it'

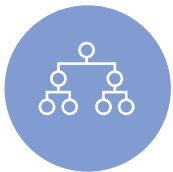

TAYLOR'S CURRICULUM FRAMEWORK (TCF)

The first of-its-kind framework in Malaysia that allows you to mix and match your degree, thus gaining multiple specialties to enhance your employability



PROFESSIONAL RECOGNITION

Our Architecture and Quantity Surveying degrees are accredited by local and international professional boards that raise the bar of our graduates and ensure they meet international industry standards.

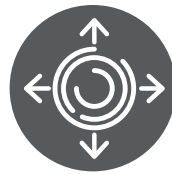

EXTENSIVE EXPOSURE

Our students attend site visits, field trips, technical visits, participate in professional network annual gatherings around the world to expand their scope of cultures, languages, design ideas and construction techniques.



LEVERAGED NETWORKING

Our extensive academic links and industry network provide opportunities for collaboration in teaching, learning, research and student mobility. The programmes are benchmarked against the industry's best practices to equip our students for success.



WORLD-CLASS STANDARDS & FACILITIES

Our campus is built with our students in mind – your university is your second home. Taylor's Lakeside Campus encompasses a modern, functional design with state-of-the-art facilities together with lush greenery and its trademark 5.5-acre lake; striking a balance between form and function to embody our modern approach and perspective in premium education with an approach to holistic growth outside the classroom.



PERSONALISED AI-POWERED LEARNING

As one of Malaysia's pioneering institutions in AI-driven innovation, we offer personalised one-on-one 24/7 tutoring, focused Q&A sessions, assessments and instant feedback, supported by our AI teaching assistant. Students enjoy an engaging experience that encourages self-directed growth and better understanding.

RESEARCH TO FUEL INNOVATION

Research at the School of Architecture, Building and Design (SABD) focuses on Innovative Tropical Cities. Our postgraduate research highlights social sustainability, heritage empowerment and innovative solutions in the context of tropical cities in Asia. We encourage digital innovation as a tool and solution to many of the diverse challenges faced by cities in the Indo-Pacific region.

Our students have visited Kampung Cina, Kuala Terengganu, to examine the site and produce detailed drawings used to restore a temple to its former glory, after it was partly ruined in a fire.

Some of our other student research projects include:

1. Guang Zhong Folk Art Museum, Xi An, China
2. Modern Architecture Kuala Lumpur Series featuring Masjid Negara
3. Muzium Negara, Stadium Negara, Stadium Chin Woo, British Council
4. The Inventory of Sungai Buloh, Leprosy Settlements, Selangor
5. Chapel of St. Francis Institution, Malacca
6. No. 6, Hereen Street, Bandar Hilir, Malacca
7. Cheng Hoon Teng Temple, Malacca
8. Harbour Kuli Culture Gallery, Malacca
9. Church of St Theresa, Malacca
10. Melaka Fui Chew Association, Malacca
11. Geographer Café, Malacca
12. Fwu Chang Trading, Malacca
13. Johor Old Chinese Temple, Johor Bahru
14. Hilltop Private School, Johor Bahru
15. Church of the Immaculate Conception Johor, Johor Bahru
16. Kedah State Art Gallery, Alor Setar, Kedah
17. Kedah Royal Museum, Alor Setar, Kedah
18. Kedah Old State Museum, Alor Setar, Kedah
19. Rumah Tok Su, Alor Setar, Kedah
20. Rumah Encik Nazim, Alor Setar, Kedah
21. Sun Yat San Museum, Georgetown, Penang
22. Ng Clan Association, Georgetown, Penang
23. Wu Di Temple (Temple of the God of War), Georgetown, Penang
24. Toi Shan Nin Yong Association, Georgetown, Penang
25. State Chinese Penang Association, Georgetown, Penang
26. No. 5,6,7, Lorong Ikan, Georgetown, Penang
27. Church of the Immaculate Conception Penang, Georgetown, Penang
28. Residence of Ku Din Ku Meh, Georgetown, Penang
29. Wisma Yap Chor Ee, Georgetown, Penang
30. No.28, Kimberly Street, Georgetown, Penang
31. No.94, Lebu Melayu, Georgetown, Penang
32. Ipoh Railway Station, Ipoh, Perak Darul
33. Ridzuan Museum, Ipoh, Perak
34. Ipoh Town Hall, Ipoh, Perak
35. Lim Ko Pi, Ipoh, Perak
36. Sarang Paloh, Ipoh Perak
37. Sin Sze Si Ya Temple, Kuala Lumpur
38. St. Mary Cathedral. Kuala Lumpur
39. Royal Selangor Club, Kuala Lumpur
40. No.3 & No.28, Jalan Stesen 1, Klang, Selangor
41. Church of Our Lady of Lourdes, Klang Selangor

BECOME FUTURE-PROOF

GLOBAL AND LOCAL LINKAGES WITH THE INDUSTRY AND PANELS



INDUSTRY EXPOSURE

We teach students how to understand industry needs and behaviours, challenge conventions and think out-of-the-box through industry exposure.



LEVERAGED NETWORKING

Our extensive academic links and industry alliances ensure that our programmes are benchmarked against industry standards, thus remaining relevant with the latest trends.



PROFESSIONAL NETWORKS

Students can participate in annual gatherings organised by Pertubuhan Arkitek Malaysia (PAM), The Royal Institution of Chartered Surveyors (RICS) and The Royal Institution of Chartered Surveyors Malaysia (RISM), providing them invaluable networking opportunities.



INDUSTRY ADVISORY PANEL (IAP)

The IAP consists of leading professionals and industry experts, who work closely with us to ensure that the curriculum offered is up to date with current industry practices and requirements, assisting students with industry placements and career opportunities.



EXPOSURE TO CREATIVE SOLUTIONS

We provide various platforms for students to compete, showcase and highlight their work, at national and international levels.



CONFERENCES

These interactive platforms are an opportunity for students to showcase and present their work every semester, to a panel of industry members and academics from different backgrounds to gain valuable feedback.

AWARDS & RECOGNITION

PROFESSIONAL RECOGNITION

- Our programmes meet the rigorous standards of professional accreditation boards, due to our stringent entry requirements, comprehensive curriculum, students' work, and achievements, as well as our qualified teaching faculty.
- First private university to be accredited by the Board of Architects Malaysia or Lembaga Arkitek Malaysia (LAM).
- Meets the requirements of LAM, our programme ensures graduates are eligible for exemption from the LAM Part 1 Examination.
- The Quantity Surveying (QS) programme is acknowledged and accredited by leading international boards, including the Royal Institution of Chartered Surveyors (RICS), the Pacific Association of Quantity Surveyors (PAQS) and the Board of Quantity Surveyors Malaysia (BQSM).
- RICS accreditation places our QS graduates on par with international standards, meeting the requirements for professional surveyors from over 140 countries.

These professional recognitions enhance our students' career opportunities and ease the pathway for them to further their studies or pursue a professional qualification.



BOARD OF ARCHITECTS MALAYSIA OR LEMBAGA ARKITEK MALAYSIA (LAM)

The Board of Architects Malaysia or Lembaga Arkitek Malaysia (LAM) is the Malaysian statutory authority responsible for the enforcement of the Architects Act. The Board has many roles and functions, one of them is to accredit architectural programmes offered in Malaysia.



BOARD OF QUANTITY SURVEYORS MALAYSIA (BQSM)

Board of Quantity Surveyors Malaysia (BQSM) is a statutory body, governing the quantity surveying profession and promoting the growth of the quantity surveying profession through regulation and continuous professional development.



ROYAL INSTITUTION OF CHARTERED SURVEYORS (RICS)

The Royal Institution of Chartered Surveyors (RICS) is the world's leading professional body for qualifications and standards in property, land and construction. RICS membership offers a global passport to professional opportunities in more than 140 countries.



PACIFIC ASSOCIATION OF QUANTITY SURVEYORS (PAQS)

The Pacific Association of Quantity Surveyors (PAQS) is an international association of national organisations representing quantity surveyors in the Asia and Western Pacific region. One of the main roles of PAQS is to promote best practices of quantity surveying in the region.

RECOGNITION FOR PUSHING BOUNDARIES

2024



16TH INTERNATIONAL SURVEYING CONFERENCE FOR UNDERGRADUATES (ISCU 2024)

Kennedy Tiong Kwong Shin won Gold Award, Best Innovation Award and Potential Research Award
Joseph Chong Khen Tshung won Special Mentioned Paper Award and Potential Research Award



SAINT-GOBAIN ARCHITECTURE STUDENT CONTEST 2024 NATIONAL STAGE - MALAYSIA

First Prize: Eunice Lim Min Yee - Master of Architecture
Second Prize: Sham Hoe Cheong & Calista Chia - Bachelor of Science (Honours) in Architecture
Third Prize: Tan Tze Qing - Bachelor of Science (Honours) in Architecture



SAINT-GOBAIN ARCHITECTURE STUDENT CONTEST 2024, HELSINKI, FINLAND

Teacher Prize Award: Eunice Lim Min Yee - Master of Architecture



ANUGERAH KHAS YB MENTERI PENDIDIKAN TINGGI REKABENTUK KURIKULUM & PENYAMPAIAN INOVATIF (AKRI) 2024

Johan, Kategori Kurikulum Program Pengajian Inovatif
Mr. Mohd Adib Ramli, Assoc. Prof. Dr. Veronica Ng Foong Peng, Ts. Dr. Filzani Illia Ibrahim, Ts. Bashira Mohd Bahar
Bachelor of Science (Honours) in Architecture



REKA AWARD BY MALAYSIAN INSTITUTE OF INTERIOR DESIGNERS

SILVER AWARD WINNER:
Jessie Chen Vern Ern - BA (Hons) in Interior Architecture
BRONZE AWARD WINNER:
Foo Shiao Jie - BA (Hons) in Interior Architecture
HONORABLE MENTION:
Nicholas Rosadi - BA (Hons) in Interior Architecture
HONORABLE MENTION:
Phuah Ru Shen - BA (Hons) in Interior Architecture



PAPER POWER PROJECT BY RAMBOLL MALAYSIA 2023 WINNER:

Chang Shi Pei, Cheng Xin Tung, Chow Yong Xuan, Lee Lizanne, Daryln Sia Bachelor of Science (Honours) in Architecture
Master of Architecture



AYDA AWARD 2023 (ARCHITECTURE CATEGORY)

Top 12 Finalist: Yeong Zhi Min
Bachelor of Science (Honours) in Architecture



AUTODESK ASEAN INNOVATION AWARDS 2023

Future Pillar of the Year Winner: Ts. Khairool Aizat Ahmad Jamal (Lecturer)
Bachelor of Science (Honours) in Architecture



MALAYSIAN INSTITUTE OF INTERIOR DESIGNERS STUDENT SATURDAY MIIDSS25:10

GOLD AWARD WINNER - EVENT REELS:
Loo Zhen Hui, Tan Xin Lin - BA (Hons) in Interior Architecture
GOLD AWARD WINNER - COMMERCIAL DESIGN:
Soh Huay Xin - BA (Hons) in Interior Architecture
GOLD AWARD WINNER - INSTITUTIONAL DESIGN:
Liow Yuh Qing - BA (Hons) in Interior Architecture
SILVER AWARD WINNER - COMMERCIAL DESIGN:
Puah Ru Shen - BA (Hons) in Interior Architecture
HONORABLE MENTION - INTEGRATED DESIGN:
Nicholas Rosadi - BA (Hons) in Interior Architecture
HONORABLE MENTION - HOSPITALITY DESIGN:
Jessie Chen Vern Ern - BA (Hons) in Interior Architecture



AYDA AWARDS

FINALIST: Phuah Ru Shen - BA (Hons) in Interior Architecture



ADA STUDENT ICONS

2ND PRIZE WINNER: Jessie Chen Vern Ern - BA (Hons) in Interior Architecture

2023



RISM GOLD MEDAL AWARD

Amanda Moh Ting Siew
Bachelor in Quantity Surveying (Hons)



Glodon 5D BIM contest 2023

1. CHAMPION
2. CREATIVITY PRIZE
See Wen Jie, Ng Kai, Low Wei Kang, Hailey Ng Wen Yi, Steve Ang



CIOB BEST STUDENT AWARD

Amanda Moh Ting Siew
Bachelor in Quantity Surveying (Hons)



AMERICAN STANDARD DESIGN AWARD

1ST PRIZE WINNER:
Grace Wong Jing Yee - BA (Hons) in Interior Architecture
2ND PRIZE WINNER:
Sarah Binnabhan - BA (Hons) in Interior Architecture



DAIKIN YOUTH DESIGN AWARD

GOLD AWARD WINNER:
Foo Shiao Jie - BA (Hons) in Interior Architecture
SILVER AWARD WINNER:
Liow Yuh Qing - BA (Hons) in Interior Architecture

2022



PAM STUDENT AWARDS 2022

BRONZE CATEGORY
Calvin Choong Li Xin; Wong Hau Nam - Stage 2 Final Judging
SILVER CATEGORY
Cho Ken Ying - Stage 2 Final Judging



REKA AWARD BY MALAYSIAN INSTITUTE OF INTERIOR DESIGNERS

EMERGING DESIGNER AWARD WINNER
- Dr Vickram Thevar Vijayan - BA (Hons) in Interior Architecture
BRONZE AWARD WINNER:
Alson Lum Zhi Hau - BA (Hons) in Interior Architecture



MALAYSIAN INSTITUTE OF INTERIOR DESIGNERS STUDENT SATURDAY MIIDSS24:09

1ST PRIZE WINNER - COMMERCIAL DESIGN:
Chong Yi Qing - BA (Hons) in Interior Architecture
1ST PRIZE WINNER - SKETCHING LECTURER CATEGORY:
IDr Mohd Redzwan Hisham Bidin - BA (Hons) in Interior Architecture
1ST PRIZE WINNER - FASHION HEADGEAR:
Year 1 Group Submission - BA (Hons) in Interior Architecture
2ND PRIZE WINNER - INSTITUTIONAL DESIGN:
Ivan Khoo Yun Fan - BA (Hons) in Interior Architecture
2ND PRIZE WINNER - FURNITURE INSTALLATION:
Year 1 Group Submission - BA (Hons) in Interior Architecture
2ND PRIZE WINNER - VIRTUAL PERFORMANCE:
Year 1 Group Submission - BA (Hons) in Interior Architecture
3RD PRIZE WINNER - HOSPITALITY DESIGN:
Salsabila Dafika - BA (Hons) in Interior Architecture



AYDA AWARDS

SILVER AWARD WINNER:
Michelle Ting Yi Wen - BA (Hons) in Interior Architecture



EVENT SHOWCASING PROJECTS

Religious Traditional Architecture
Measured Drawing & Model Exhibition

EXTENSIVE EXPOSURE

Students are exposed to real life scenarios and industry-relevant experiences. By participating in site visits, they learn how to compose and analyse space, beyond their screens and textbooks.

FIELD TRIPS

Students undertake educational visits to various places of interest both locally and abroad, such as art galleries, historical sites, and factories to witness the concept of architecture and design in practice.

- Dive Centre, Pulau Redang
- Jonker Street, Malacca
- Taiping Zoo, Perak
- Signal Hill Community Centre, Sabah
- Egyptian Tourism, KL
- Chew Jetty, Penang

- Bentong, Pahang
- Cameron Highlands, Pahang
- Bauhaus International Summer School, Dessau, Germany
- London, Edinburgh & York, United Kingdom
- Henderson Wave Bridge, Singapore
- Gardens by the Bay, Singapore
- Royal Selangor Visitor Centre, Selangor
- Church of Our Lady of Guadalupe, Selangor
- Rimbun Dahan, Selangor
- Port Dickson, Negeri Sembilan
- Photovoltaic (PV) System Manufacturing Factory, Pahang
- Daikin Solution Plaza, Desa Parkcity
- KIAN Contract, Sungai Buloh Selangor
- Muzium Negeri Terengganu, Terengganu
- Sekeping Kong Heng, Ipoh Perak
- Sekeping Serendah, Selangor



Architecture, Community & Memories: Jln Stesen 1,
Klang Measured Drawing Project Sharing Session



Melaka Measured Drawing & Local
Community Old Photographs Exhibition

TECHNICAL VISITS

On-site technical visits provide students an opportunity to understand industry construction methodologies, project management concepts, tools and techniques.

- Morib Sandcastle Building Competition
- Kelana-Subang Elevated Highway Link
- The Pinnacle Sunway Site Visit
- PAM Architecture Student Workshop
- RICS-RISM International Undergraduate Student Conference
- Royal Institution of Surveyors Malaysia (RISM) International Research Conference
- Hyundai Veloster Rev-It-Up Inter-College Challenge
- Penang Eco Retreat Student Ideas Competition
- KL Pac Open Day
- Creative Mafia @ Youth
- CIDB•CIOB Youth Arena Convention Malaysia 2023
- Sustainability Development Goals: Shaping the Future of Construction
- CIOB MALAYSIA Inter-university Students' Challenge 2023



INTERNATIONAL EXPOSURE

As your vested partner throughout your education journey, future-proofing you is our priority. To do that we ensure our students have local and international exposure.

INTERNATIONAL MOBILITY PROGRAMME

Students can expand their scope of cultures, languages, design ideas and construction techniques with travel experiences to destinations around the world. This gives them first-hand insights into how the built environment is influenced by its surroundings.



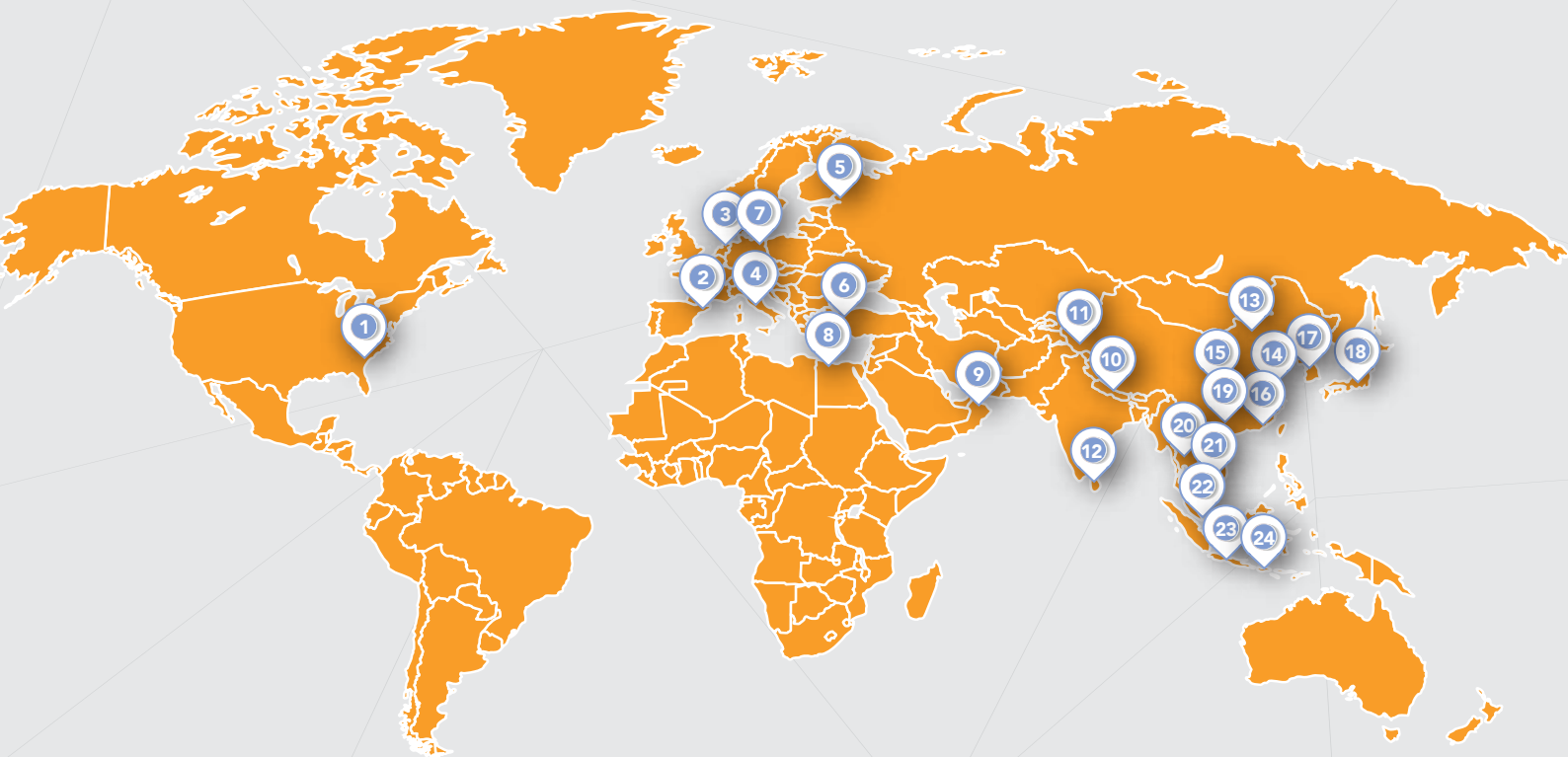

- | | |
|--------------------------------------|---------------------------|
| 1. New York, USA | 13. Beijing, China |
| 2. Barcelona, Spain | 14. Shanghai, China |
| 3. Amsterdam, Netherlands | 15. Yunnan, China |
| 4. Rome, Italy | 16. Hong Kong, China |
| 5. Moscow & Saint Petersburg, Russia | 17. Seoul, South Korea |
| 6. Istanbul, Turkey | 18. Tokyo & Kyoto, Japan |
| 7. Berlin, Germany | 19. Hanoi, Vietnam |
| 8. Cairo, Egypt | 20. Bangkok, Thailand |
| 9. Dubai, United Arab Emirates | 21. Siem Reap, Cambodia |
| 10. Nepal | 22. Singapore |
| 11. Agra, India | 23. Yogyakarta, Indonesia |
| 12. Colombo, Sri Lanka | 24. Bali, Indonesia |



The annual Activity Week allows us to travel overseas, and as an architecture student, traveling and seeing the different designs, buildings and artwork is truly inspirational.

I personally love to learn from experience instead of the traditional academic approach, so the fact that we are given the chance to travel with our peers and lecturers, is great!

Sarah Ahmad



WORLD-CLASS STANDARDS & FACILITIES

As your vested partner throughout your education journey, we continuously provide our students with more than just academics, but also life skills to be business leaders and successful entrepreneurs of the future. To do that, we ensure we upkeep our standards and facilities, to be nothing less than world-class.



TAYLOR'S VORTEX XR LAB

Taylor's University has expanded its education from classroom and online lectures into the virtual world of extended reality (XR). XR is an emerging umbrella term describing current immersive technologies, namely augmented reality (AR), virtual reality (VR) and mixed reality (MR). The lab facilitates the virtual co-presence of learners and participants in a virtual metaverse.

Students, lecturers and staff can enter into a world where they can experience complete liberation from screen-bound experiences and venture into XR.



Jeffrey has worked in the WTA architecture and design studio in the Philippines previously and has participated in the construction of the Emergency Quarantine Centre during the pandemic. He now runs his own business and is also working in Johor.

Jeffrey Cheah
FNBE and BSc (Honours) in Architecture



Heffrence works in WOHA, a renowned architecture office in Singapore, specialising in sustainable architecture. He still submits ideas for competitions and gets recognitions being published in online architecture/design platforms.

Heffrence Teow
Master of Architecture
Associate, WOHA, Singapore



Mac Lab

TAYLOR'S LAKESIDE CAMPUS

Flexible learning spaces

EXTENSIVE LEARNING SPACES

- X - Space
- Science Lab
- Mac Lab
- Library
- Computer Lab

HOLISTIC STUDENT SERVICES

- Career Services Centre
- Sick Bay
- Counseling and Psychological Services Centre
- U-Residence

TOP QUALITY FACILITIES

- Study room
- The Grand Hall
- Lecture Theatre
- Sports and Recreation Centre
- Student Life Centre
- UniGym



Sick Bay



CHED



X - Space



Arcadia



Sport Complex

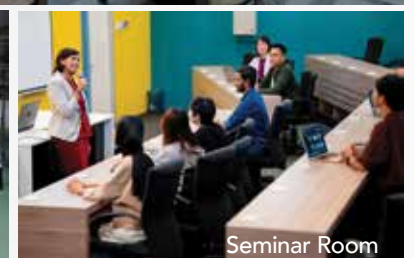

Seminar Room

SHOWCASE

WHAT OUR STUDENTS STAND FOR MORE

Cheah Chen Xi

Architectural Design I - Interpretation & Representation

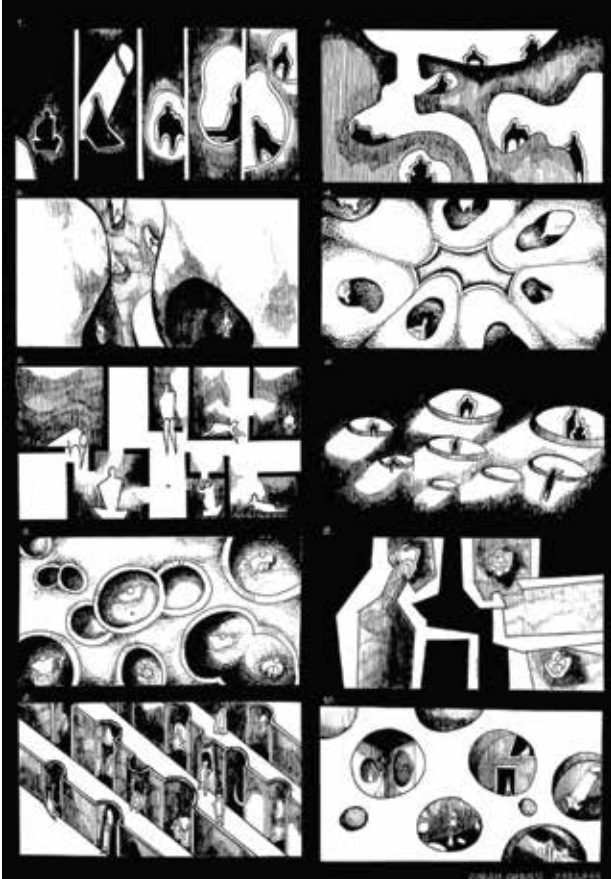

Chai Paul Le

Architectural Design II - Experiential Pavilion

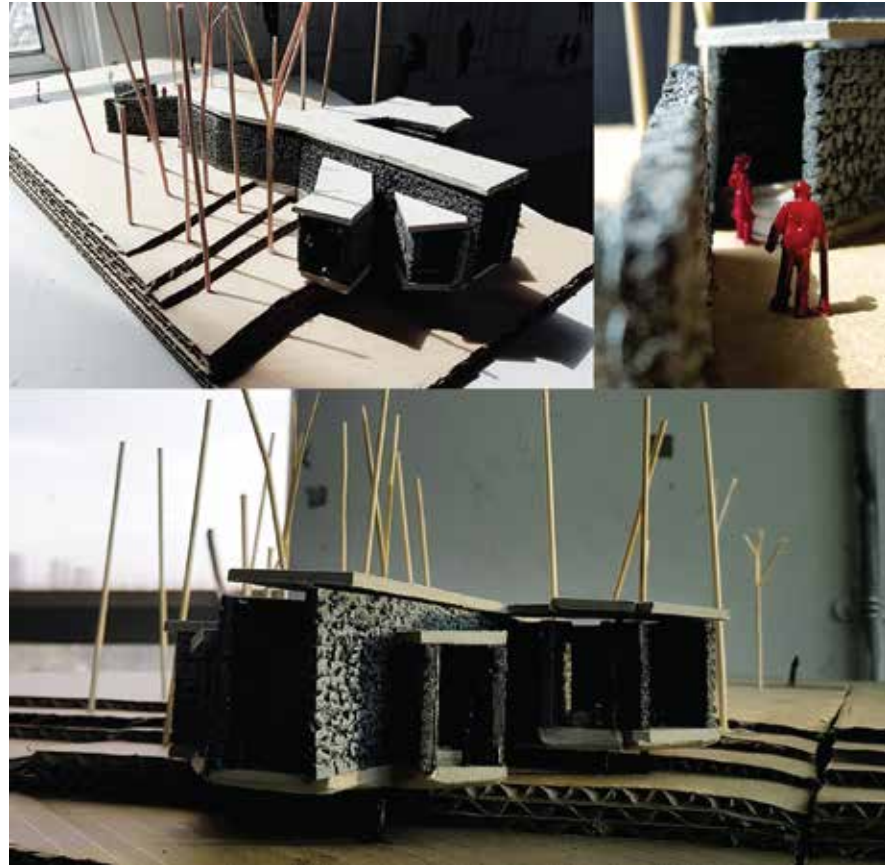

Yew Jey Yee

Architectural Design III - Visitor Interpretive Center

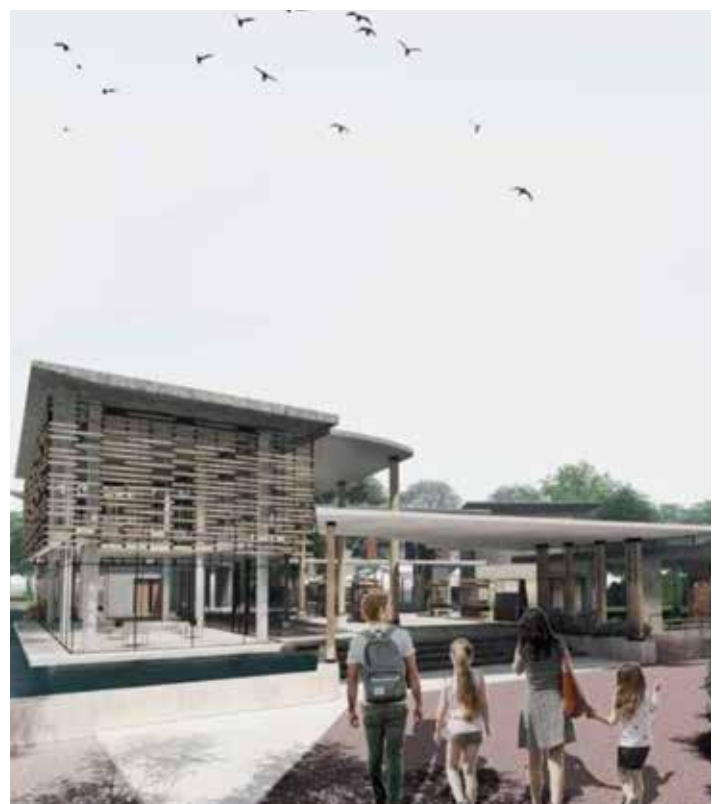

Ryan Sak

Architecture Design IV - Center for Single Mothers

Abirami Ravichandran, Ang Jia Qin,
ackson Goh Ding Yuan, Lee Wen Yi,
Mohamed Amin Abubakar
Architectural Design I - 1:1 Tectonics



Timothy Tang Ing Wang
Architectural Design II
- Experiential Pavilion



Rachael Lim Feng Yi
Architectural Design III - Visitor Interpretive Center



Ng Kwang Zhou
Architectural Design Project - Co-Working: A Collaborative Community



Barbara Chang Huey Yi
Architectural Design Project
– Co-Working: A Collaborative
Community

REFERENCE LIST

Ferro, S. (2015, March 03). 5 Trends Shaping the Future of Architecture. Retrieved from FastCompany: <https://www.fastcompany.com/3042937/5-trends-shaping-the-future-of-architecture>

Gold, J. (2019, January 3). Three Hot Wellness Architecture Trends For 2019. Retrieved from Forbes: <https://www.forbes.com/sites/jamiegold/2019/01/03/three-hot-wellness-architecture-trends-for-2019/#7ff801f4f2ac>

Grozdanic, L. (2015, November 21). 5 Emerging Trends that will shape the future of architecture. Retrieved from Archipreneur: <https://archipreneur.com/5-emerging-trendsthat-will-shape-the-future-of-architecture/>

Holmes, D. (2019, January 14). Landscape Architecture trends for 2019. Retrieved from Worldlandscapearchitect: <https://worldlandscapearchitect.com/landscape-architecture-trends-for-2019/#.XHNjaZul2w>

LTD, T. S. (2017, January 6). Emerging Trends that will shape the future of architecture. Retrieved from Medium: <https://medium.com/studiotmd/emerging-trends-that-will-shape-the-future-of-architecture-356ba3e7f910>



Kelvin Bong Jia Ying
Architecture Design V
- Learning Center for All

Ellyn Peh
Architecture Design IV
- Center for Single Mothers

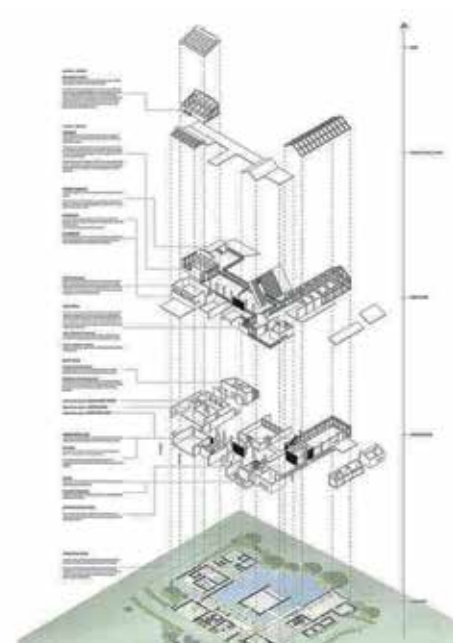

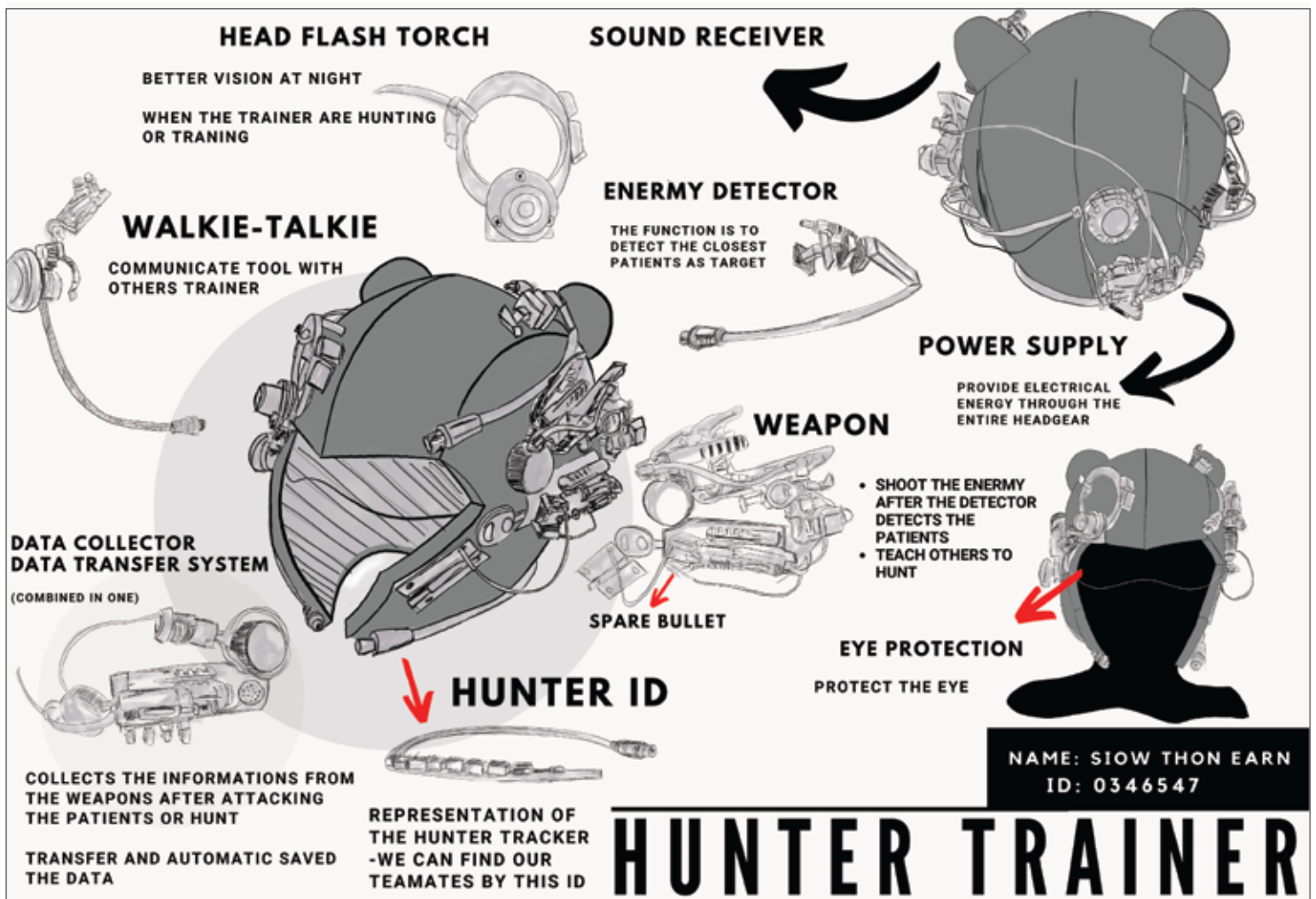

Siow Thon Earn
Interior Architecture Design I - Fun[k]tional Machine - Headgear



Shermaine Kong
Interior Architecture Design I - S[hell]ter



Angel Chong Kim Yong
Interior Architecture Design III
- Confluence of Communal Hub
for Riders



Soh Huay Xin
Interior Architecture Design IV - WISTERIA

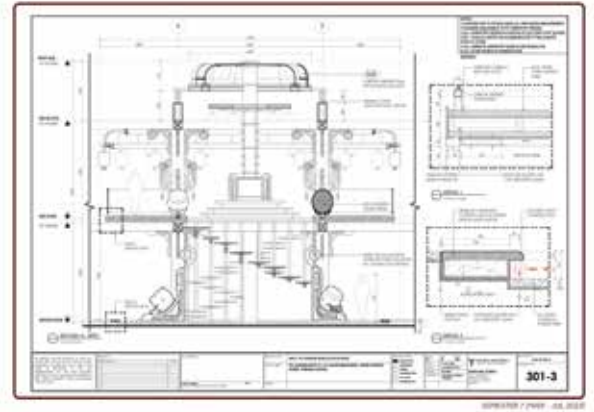
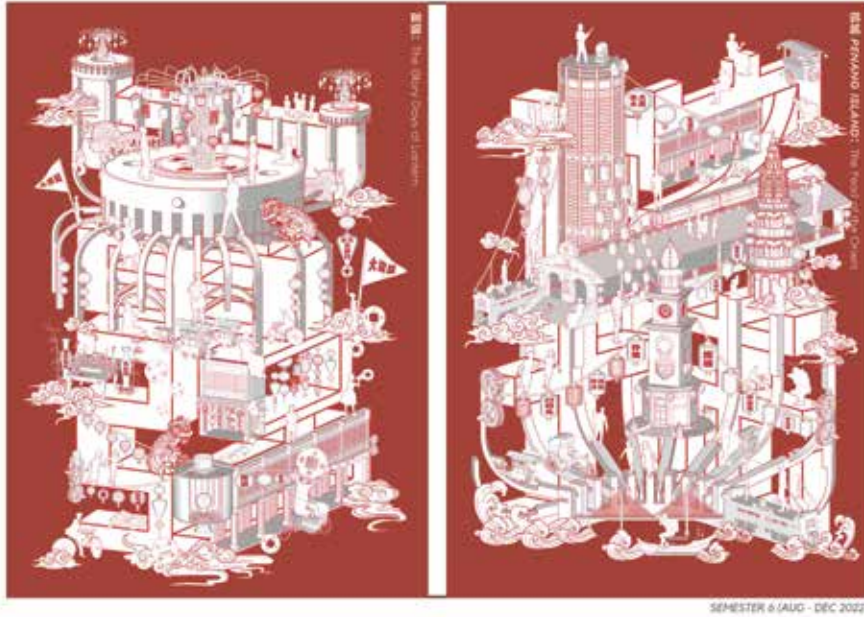

Phuah Ru Shen
Advanced Interior Architecture Design II
- To-Gather-Nest



Sarah Mohamed
Advanced Interior Architecture Design I
- Ethereal Dreams

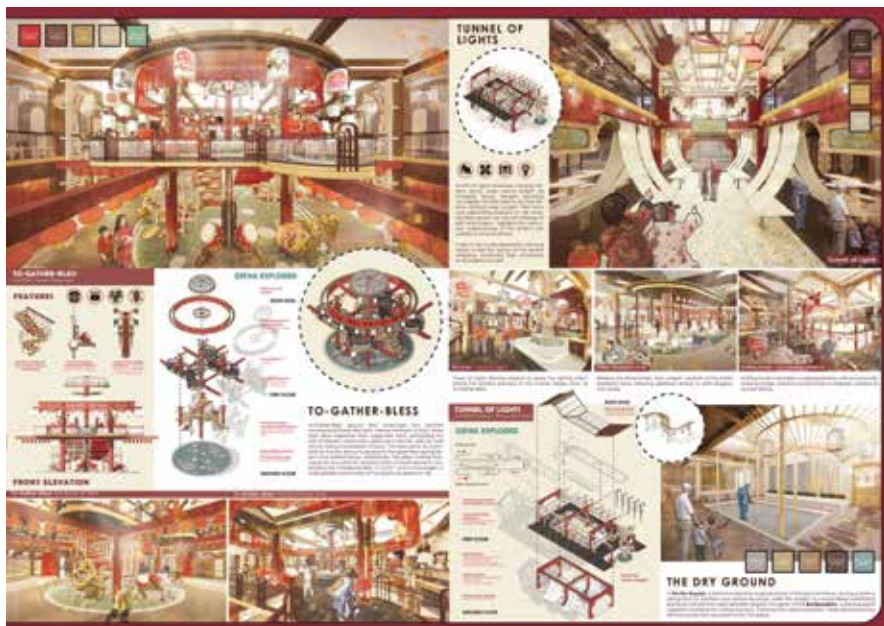

GLOBAL CONNECTIONS



OVER **200**
UNIVERSITY PARTNERS

LEADERS

IN THE
GLOBAL
COMMUNITY



STUDENT EXCHANGE

SHORT TERM

MOBILITY

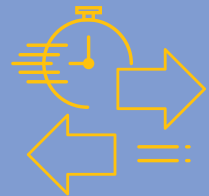

Taylor's is strongly committed to its mission of empowering the youth of the world through education, so that they may take their productive places as leaders in the global community.

As one of Malaysia's oldest, most successful and reputable private education institutions, Taylor's provides quality education and exposes students to the vast possibilities that await them beyond the classroom walls.

Through its partnerships with international universities and industry members, Taylor's is committed to providing an outstanding educational experience, guiding and helping students realise their potential to obtain a world-class qualification that meets the requirements of a dynamic, global marketplace.

GLOBAL EXCHANGE EXPERIENCES

Are you eager to become a global citizen, broaden your horizons, and enrich your international perspective? Taylor's Global Mobility Programme provides students with the opportunity to widen their international exposure allowing students to gain new knowledge and skills in an area that is of interest to them thus benefiting from a multi-disciplinary learning environment and give their Taylor's degree an international edge.

SCAN TO
LEARN MORE



TAYLOR'SPHERE CONNECTIONS & SUPPORT

RESEARCH AND TECHNOLOGY INNOVATION

Taylor's University has a firm footing in research and technology innovation as we believe these efforts will contribute towards knowledge building and assist in the development of the industry and society at large now and for the future. We adopt a progressive outlook, embedding research components throughout our programmes and encouraging them at various levels in each faculty.

OUR RESEARCH CENTRES PLAY A CRUCIAL ROLE IN ELEVATING THE CAPABILITIES OF OUR FACULTY MEMBERS THROUGH VARIOUS TRAINING ACTIVITIES AND TECHNOLOGY, MAKING US WORLD-CLASS.



BACHELOR OF QUANTITY SURVEYING (HONOURS)

3.5-Year
Programme

KPT/JPS (R2/526/6/0056) (MQA/FA8178) 03/26

INTAKES: FEBRUARY, APRIL & SEPTEMBER

The Bachelor of Quantity Surveying (Honours) adopts an integrated approach to provide students with the knowledge base in the construction industry from the technical, commercial and contractual aspects. This will concretise their understanding in the context of the Quantity Surveyor's role as the industry advisor on the value and cost of construction projects from inception to completion – cost budgeting & control, procurement, contract administration and project management achieved through guided learning as well as, whole-class and structured group work and individual activity. Through these activities, students acquire sound knowledge of building and the built environment, ability to translate drawings into bills of quantities, and develop initiative and imagination to visualise building design details for accurate costing. This is culminated with organisational ability, tact, patience, intuition, common sense, logical thinking to solve problems and ability to write and communicate clearly. The curriculum is underpinned by multidisciplinary, collaborative, and real-world learning pedagogies. It includes a 6-month industrial training to develop practical and relevant skills for future employment.

Professionally Accredited Graduates

- Graduates gain automatic membership to the Board of Quantity Surveyors Malaysia (BQSM) or Lembaga Jurukur Bahan Malaysia.
- Graduates gain recognition from a network of over 140 countries through the Royal Institution of Chartered Surveyors (RICS).
- Accreditation from The Pacific Association of Quantity Surveyors (PAQS).

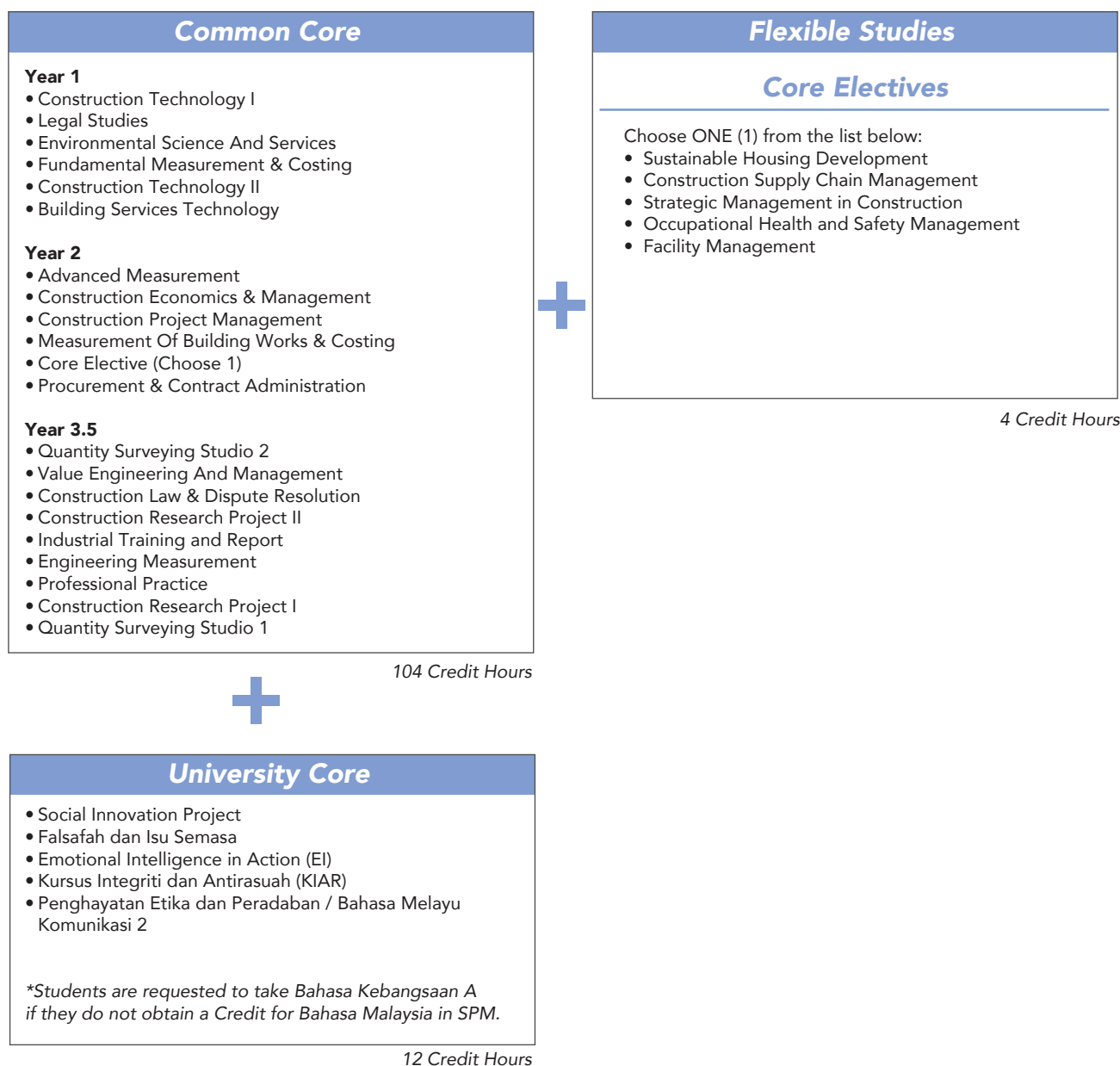

Note :

Primary Core + University Core + Electives = Min. 3.5 Years (120 Credits)

MODULE SYNOPSIS

Construction Supply Chain Management (Elective Module)

Construction Supply Chain (CSC) is the network of organisations involved in different stages (the upstream and downstream) of processes of delivering goods or services. The module covers the coordination of material, information and financial flows between and among all the participant organisations including the current trends within the CSC such as lean and agile concepts, relationship management and corporate social responsibility (CSR).

Facility Management (Elective Module)

Facility management is to focus on coordinating all business support services and property management techniques. The coordination emphasises adding value to the business operation and to society. Facility management plays an important role to bridge the gap between business operation and the environment.

Occupational Health and Safety Management (Elective Module)

The module covers aspects that help to promote a safe working environment that includes the understanding of safety problems and jobsite conditions, safety laws and regulations, effective safety management systems, safety training as well as the government's safety initiatives.

Strategic Management (Elective Module)

This module introduces the fundamental concepts of strategic planning and management in the context of the real estate, design, and construction industry. It also discusses the basic business relationships among firms in the design and construction value chain.

Sustainable Housing Development (Elective Module)

This module covers basic knowledge of global environmental issues and the principles of ecologically sustainable development to a large-scale housing development.

Industrial Training

Industrial training provides students with the opportunity to gain working experience, correlate theory with practice within the quantity surveying environment, explore potential career paths and gain competitive advantage in the job market upon graduation.

Construction Research Project I

This module emphasises the basic research. It is aimed to guide the students to explore a range of research methods and select an appropriate research topic for the following Construction Research Project II module.

Construction Research Project II

This module is a continuation of Construction Research Project I. Students will be continuing their research by an appointed supervisor, leading to writing a critical piece of dissertation.

Construction Economics and Management

This module provides an overview of the Quantity Surveyor's role during the pre and post-tender stage of a development which is initiated with the introduction of the process in a property development and factors that influence the development process. The module also covers principles and practices of project cash flow, financial management and various techniques of development appraisal including sources of finance available, the importance of budgeting, budget monitoring and its control throughout the development process.

Quantity Surveying Studio 1 & 2

This module encompasses the summary of the knowledge and skills that students acquired in the earlier semesters. For this module, students are required to apply the knowledge and skills they have learnt throughout the QS programme in a Multidisciplinary Learning Environment "MLE" collaborative setting. Students get to learn how to collaborate in a wider project based collaboration together with students from other industry-related disciplines. The assignment covers an extensive spectrum of the Quantity Surveying profession from project inception to final accounts.

Value Engineering and Management

This module introduces the history, background, theories, concepts and principles of Value Management/Value Engineering in the decision-making process of construction projects from concept to completion.

Construction Law and Dispute Resolution

This module provides an understanding of the principles of construction law and its applications. It covers the importance of adhering to the specific procedures and notices are emphasised to develop an in-depth knowledge on the application of the law and the remedies available to the parties.

Professional Practice

This module introduces the base knowledge of contract administration and the provisions of the standard contract conditions. It covers the understanding of a professional approach to procedural requirements of the contract and its limitations and the industry's practice of professional services.

Construction Project Management

Emphasises the theories, concepts and principles of management and project management in construction industry particularly in the overall processes from inception, evaluation, implementation, monitoring and finally until project completion.

Legal Studies

Basic aspects of Malaysian law and the role it plays in the construction industry which include the Malaysian Legal System, Contract Law and Tort Law.

Procurement and Contract Administration

Focuses on the professional code of conduct and a basic knowledge of contract procurement by identifying the various procurement methods in executing a project including legal and contractual procedures and developing an awareness of the provisions of the Standard Contract forms and other clauses forming the basis of contracts.

Environmental Science and Services

Provides an introduction to services that are commonly provided in a building, primarily cold water treatment and supply, sewerage disposal and treatment, storm water management, ventilation and telecommunication services. Students are made familiar with basic requirements, Uniform Building By-Law (UBBL), planning, coordination and installation of these services.

Building Services Technology

This module introduces students to the basic services systems that are provided in buildings such as mechanical ventilation, air-conditioning, fire protections, electrical supply, and mechanical transportation. Students will also learn about statutory requirements related to building design such as the Uniform Building By-Law (UBBL) and other relevant laws, guidelines and standards related to the subject matter.

Construction Technology I

Enables the development and establishment of a base knowledge of the fundamental principles of design, materials and technology of foundations, piled foundation, concrete framed buildings, walls, windows, doors. The students are also introduced to the principles of sketching.

Construction Technology II

Enables the development and establishment of a base knowledge of the fundamental principles of foundations, structural and load distribution, piled foundation, pre-stressing, steel portal frames, precast concrete and IBS, pre-stressing, dewatering and retaining wall. The students are also introduced to the principles of sketching.

Fundamental Measurement and Costing

Covers the principles, purpose, and function of the Standard Method of Measurement (SMM) including measurement principles, descriptions, and standard phraseology in the measurement of structural works. This module also provides an introduction on the principles of estimating and component prices such as material, plant, wastage, profit, and labour.

Measurement of Building Works and Costing

Covers the measurement of architectural works based on the Standard Method of Measurements for Building Works. This module also covers the principle of estimating and component prices such as material, plant, wastage, profit and labour for building works.

Advanced Measurement

Covers the measurement of roofs, structural steelwork, piles foundation, renovation & demolition works and various elements of external works. The module also integrates computing into their discipline of study by teaching the students to use relevant computer software programmes to prepare Bills of Quantities.

Engineering Measurement

Focuses on the measurement of civil engineering works namely bridges, retaining walls, earthworks, rail tracks, environmental protection works and based on the Malaysian Civil Engineering Standard Method of Measurement (MYCESMM), It also covers building services measurement, cold water and sanitary plumbing, electrical installation and M&E works. All measurements will be based on the Standard Method of Measurements for Building Works.



TAYLOR'S
UNIVERSITY

Wisdom • Integrity • Excellence

EDUCATION

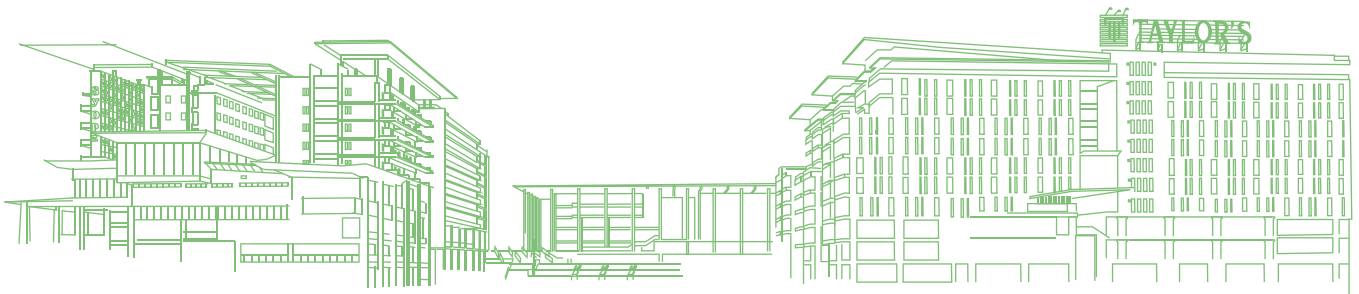

TAYLOR'sphere™

TAYLOR'S SCHOOL OF EDUCATION

WORLD'S TOP
300

NO. 1 PRIVATE UNIVERSITY IN
MALAYSIA & SOUTHEAST ASIA
FOR EDUCATION & TRAINING



WORLD
UNIVERSITY
RANKINGS

By Subject 2025

Bachelor of Education (Hons)

Specialisations

1. Primary Education
2. Teaching of English
3. Early Childhood Education
4. Special Educational Needs



EDUCATION PATHWAY

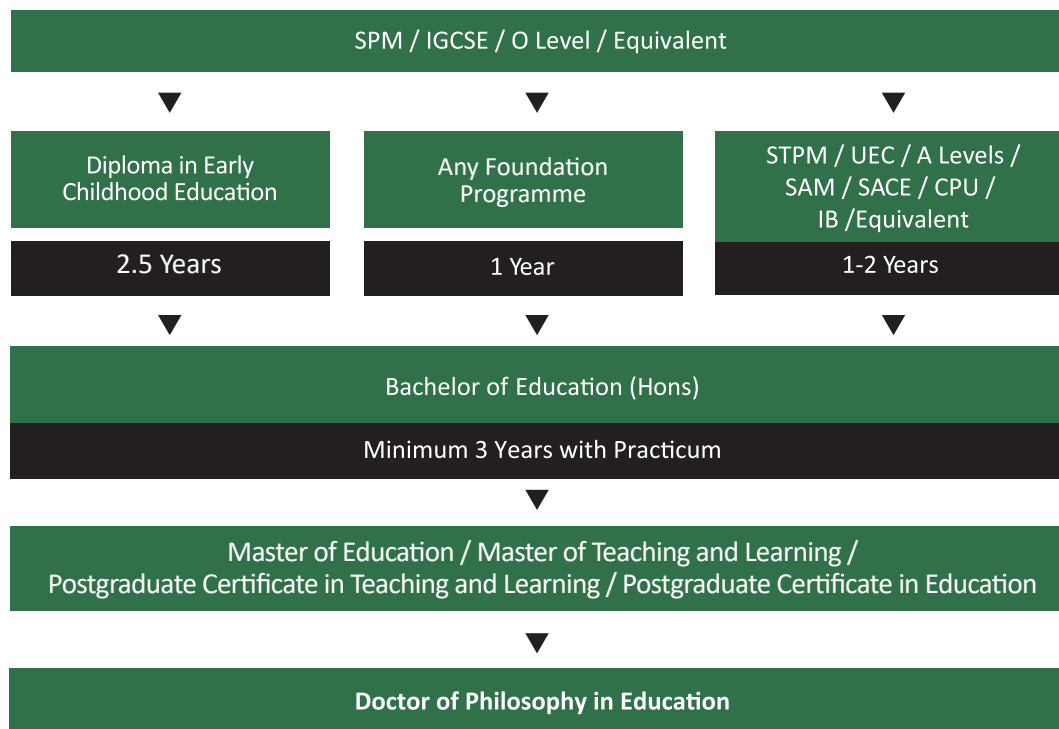

OVERSEAS TRANSFER OPTION



NEW ZEALAND

THE UNIVERSITY OF AUCKLAND

- Bachelor of Early Childhood Studies
- Bachelor of Education - Teaching English to Speakers of Other Languages



UNITED STATES OF AMERICA

UNIVERSITY OF CENTRAL MISSOURI

- MSE in English Language Learners (ELL), TESL Option



UNITED KINGDOM

UNIVERSITY OF PLYMOUTH

- BA (Hons) Education
- BA (Hons) Early Childhood Studies

**Admission is subject to the transfer requirement established by the respective universities*

INDUSTRY ADVISORY PANEL

Industry Leaders Co-designing Our Programmes

NAME	POSITION	INSTITUTION/ORGANISATION
Wong Tze Peng	Associate Professor	University of Nottingham Malaysia
Ilyia Dayana Shamsudin	Senior Lecturer	Universiti Pendidikan Sultan Idris
Sunitha Sivakumaran	Principal	Taarana
Norashikin bte Ismail	Chairman	Ashikin Holdings Sdn Bhd
Masayu Dzainudin	Senior Lecturer	Universiti Pendidikan Sultan Idris
Wong Poai Hong	Director	Childline Foundation
Peter Wells	Executive Principal	Taylor's International School Kuala Lumpur (TISKL) and Taylor's International School Puchong (TISPC)
Marco Damhuis	Head of Primary	Taylor's International School Puchong (TISPC)
David Griffiths	Principal; Chairperson	Nexus International School Malaysia; The Association of International Malaysian Schools (AIMS)
Rosanna Kirkbride	Founding Head of Primary	Concord College International School

CREATE IMPACT THROUGH THESE CAREERS

BACHELOR OF EDUCATION (HONS)

- Primary School Teacher
- Special Education Needs Teacher
- Educational Institution Administrator
- Educational Researcher
- Tutor
- Learning Mentor
- School Administrator
- Academic Librarian
- Consultant
- Corporate Trainer
- Preschool Teacher
- Preschool and Childcare Centre Director
- Homeroom Teacher
- Education Counselor
- Edupreneur
- Content Developer

WHY EDUCATION AT TAYLOR'S?

Taylor'sphere, our balanced ecosystem of community, facilities and features, is focused on equipping students with intellect, creativity and practical wisdom to graduate in demand for the ever-evolving landscape. Your journey in education studies as a Taylorian will be immersed within this ecosystem that will empower your aspirations and enable you to rise with the best, where our community is our strength.





YOUR FUTURE IS OUR PRIORITY

We ensure that our students are in touch with current and future trends, and are well-equipped to embrace the challenges of the education sector.



MULTIDISCIPLINARY LEARNING EXPERIENCE (MLE)

Taylor's is one of the pioneer institutions in the region to implement compulsory multidisciplinary projects across all its undergraduate programmes. Multidisciplinary solutions go beyond just collaborating, but rather having a good understanding of learning necessities across various disciplines against being discipline-specific which will no longer be enough.



TAYLOR'S CURRICULUM FRAMEWORK (TCF)

Breaking conventions to bring you the first-of-its-kind framework in Malaysia that allows you to mix and match modules to customise your degree.



GLOBAL AND LOCAL EDUCATION

Our students are equipped with skill sets needed to teach and manage in private, international and government schools via a combination of the National Curriculum of England and Wales through the International Primary Curriculum (IPC) and the Malaysian Primary Schools Standards Curriculum (KSSR).



DIRECT PATHWAY TO AN IQTS

Taylor's partners exclusively with the renowned TES Institute to offer Malaysia's only direct pathway to the prestigious iQTS qualification. The fast-track Assessment Only route (AO QTS) opens doors to a rewarding teaching career in the UK, Middle East, and beyond in just 3 months.



UNIQUE PRIVATE & INTERNATIONAL SCHOOL PLACEMENTS

Hands-on training at Taylor's prestigious 5-star Private and International schools. Students are given first priority job placement upon graduation.



BREAK BOUNDARIES TOGETHER

We encourage our students to break boundaries and go beyond. They are taught to create their own benchmarks and break them. Education is the ultimate foundation where relevant innovation and advancements are key for the next generation.



WORLD-CLASS STANDARDS & FACILITIES

Taylor's Lakeside Campus encompasses a modern, functional design with state-of-the-art facilities together with lush greenery and its trademark 5.5-acre lake; striking a balance between form and function to embody our modern approach and perspective in premium education with an approach to holistic growth outside the classroom.



INTERNATIONAL EXPERIENCE

Teach in private and international schools worldwide through our Assisted Language Teachers (ALT) Programme.



PERSONALISED AI-POWERED LEARNING

As one of Malaysia's pioneering institutions in AI-driven innovation, we offer personalised one-on-one 24/7 tutoring, focused Q&A sessions, assessments and instant feedback, supported by our AI teaching assistant. Students enjoy an engaging experience that encourages self-directed growth and better understanding.

TEACHING & LEARNING CURRICULUM

Our uniquely designed modules introduce different teaching methods, allowing our students to deliver their classes more effectively. Student learning experiences include community projects and reflective learning.



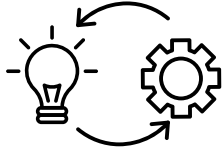

PUTTING THEORY INTO PRACTICE

Students design their own teaching material and critique their lesson plans while gaining practical experience in presenting their material in a classroom setting.

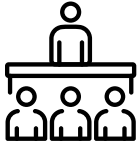

CLASSROOM MANAGEMENT

Students focus on classroom management as part of their professional practice through exploring interactions during a lesson, and ways to encourage good behaviour, establish rules and routines, and create supportive learning environments.



REFLECTIVE PRACTICE

As future educators, students are encouraged to learn from experience, specifically to understand how to use their knowledge in practical situations and how they can combine practice and learning more effectively.



The Bachelors degree of Education program at Taylors University was such a great experience. Immersed in a wonderful community of expert lecturers and enthusiastic peers, we were set on a journey to holistic development as an educator! Here is a programme bound to make you a better you!

Shevan Trinity Jayasinghe
Bachelor of Education (2023)



GLOBAL BENCHMARKS, BORDERLESS EDUCATION

Students are trained with an international curriculum, but also master the local Malaysian curriculum for added versatility.

● National Curriculum of England and Wales through the International Primary Curriculum (IPC)

● Malaysian Primary Schools Standards Curriculum (KSSR)

SCHOOL OF EDUCATION ADJUNCT APPOINTMENTS

Mr Peter Wells

Executive Principal

Taylor's International School Kuala Lumpur (TISKL)
Taylor's International School Puchong (TISPC)

Mr Marco Damhuis

Principal, Head of Primary

Taylor's International School Puchong (TISPC)

Ms Sahmalah Sakthivel

Lead Teacher Mentor

Nexus International School Malaysia

Ms Leigh Janett

Deputy Head of Junior School

Australian International School Malaysia

Mr Gan Boon Kiat

President

Taylor's Schools

Dr Hartini binti Zainudin

Vice President

Voice of the Children

Petrina Shee Satvinder

Chief Executive Officer (CEO), Principal

Dignity for Children Foundation

Ms Nalina Nadesu

Educational Therapist

NNP Education Consultancy

Mr David Griffiths

Principal

Nexus International School Malaysia

Ms Siew Ju Li

Director and Consultant

Seed Connections

Ms Sherrene Teh

Senior Music Therapist

The Energy Source, Kuala Lumpur

Ms Lee Mei Li

Clinical Psychologist

The Happy Leaves Autism
& Special Needs Therapy Centre

Ms Goh Pei Xin

Music Therapist

The Happy Leaves Autism
& Special Needs Therapy Centre

Mr Cheah Chin Teik

Founder and President

Chin Teik Consulting Ltd

IPC LEARNING PROCESS

Students gain valuable skills and experience to teach the International Primary Curriculum (IPC), a comprehensive, thematic and creative curriculum with a clear process of learning and specific learning goals for every subject.

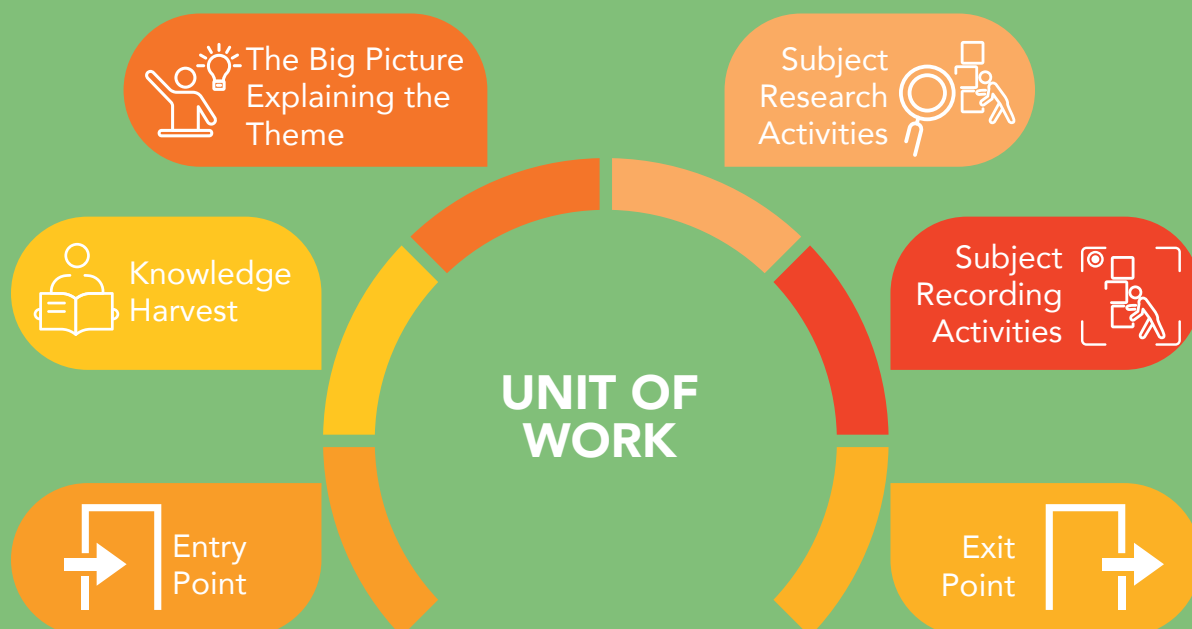



INTERNATIONAL EDUCATION EXPERT PANEL (IEEP)

We have established close collaboration with a set of advisors known as the IEEP who play a crucial role in strengthening the school's programmes and enhancing its reputation across borders.

The industry advisors are from:

- Finland
- Denmark
- Australia
- Singapore
- Malaysia

The IEEP advisors include:

- **Prof Emeritus Rahman Aroff**
Universiti Putra Malaysia
- **Prof Dr Fred Dervin**
University of Helsinki, Finland
- **Prof Anne Chapman**
University of Western Australia
- **Assoc Prof Dr Daniel Tan**
Nanyang Technological University, Singapore
- **Dr Paul Gruba**
The University of Melbourne, Australia
- **Dr Rosie Martin**
Taylor's Education Group, Malaysia



BECOME FUTURE-PROOF

UNIQUE PRIVATE & INTERNATIONAL SCHOOL PLACEMENTS

Our students undergo placements at reputable schools and have priority in securing a job placement* within the network of Taylor's Schools. Towards becoming experienced lecturers, our students are taught to see the connections between educational theories and classroom practice and how to address the gap.

OUR AFFILIATED SCHOOLS



TAYLOR'S INTERNATIONAL SCHOOL

TAYLOR'S INTERNATIONAL SCHOOL

Taylor's International School offers a global learning experience based on the British curriculum, leading to excellence in IGCSE qualifications, as well as a grounding in Eastern values.



Garden International School

Bringing Out The Best In You Since 1951

GARDEN INTERNATIONAL SCHOOL

Garden International School (GIS) is the largest private, co-educational, international school in Malaysia and is accredited by the Council of International Schools (CIS).





For Taylor's International School to work with SOEd, developing the future teachers of Taylor's schools truly establishes a partnership focused on what is really important in schools: great learning.

Mr. Peter Wells
Principal of Taylor's International School,
Kuala Lumpur



AISM
AUSTRALIAN
INTERNATIONAL SCHOOL
MALAYSIA

AUSTRALIAN INTERNATIONAL SCHOOL MALAYSIA

The Australian International School Malaysia (AISM) is the first and only International School in Malaysia offering an Australian Curriculum, delivered by Australian teachers, following the Australian school year.



NEXUS
INTERNATIONAL
SCHOOL

NEXUS INTERNATIONAL SCHOOL

NEXUS International School Putrajaya has a team of highly qualified international educators, delivering a well-balanced curriculum based on the best standards and practices used around the world.



**Our pioneer graduates achieved an impressive 100% employment rate.*

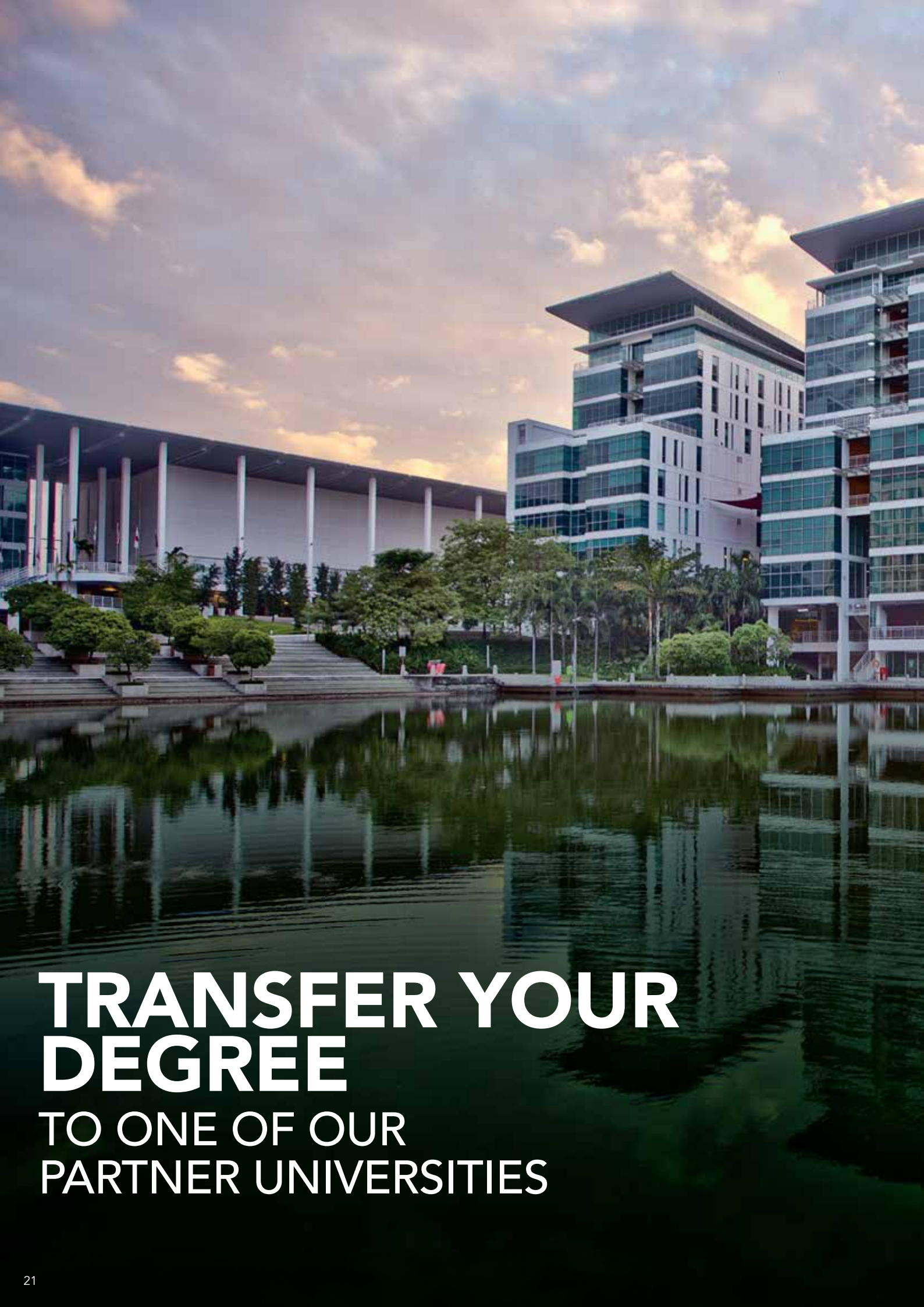

**TRANSFER YOUR
DEGREE**
TO ONE OF OUR
PARTNER UNIVERSITIES



Taylor's School of Education partners with three partner institutions for its programme articulation:

- The University of Auckland
- University of Plymouth
- University of Central Missouri



An articulation pathway is an inter-institutional agreement between Taylor's School of Education (SOEd) and our partner colleges where we align our courses and credits so that students at Taylor's can use their credits at the partner university of their choice.

INTERNATIONAL EXPERIENCE

Get international exposure by teaching overseas at private and international schools through our Assistant Language Teachers (ALT) Programme in diverse locations.

- Kita-kamakura Joshi Gakuin, Kanagawa Prefecture, Japan
- Koto International School, Japan
- La Trobe University, Australia
- Nihon University Junior and Senior High School, Japan
- Seiko Gakuin, Japan



The Bachelor of Education programme at Taylors helped me grow not only as a teacher but also as a person. Other than education modules, we had many opportunities to take other modules and electives. I loved that we were always backed by practical application. By planning lessons and carry them out both in micro-teaching activities as well as in actual classrooms, the programme prepared me well for the realities of teaching.

As a result, I was able to confidently step into the classroom as a teacher after graduating.

Gloria Ngu
Bachelor of Education (2018)

ACHIEVEMENTS



INTERNATIONAL AND NATIONAL COLLABORATION

Enabling Learning at Home (ELaH) Project with Plymouth University, UK – Development of home learning packs for autistic children, especially during the pandemic.

KISAH Project with United Nations Development Programme (UNDP) Malaysia – Collaborated as Knowledge Partner on how young people from underprivileged background coped with the pandemic and school closure.



INTERNATIONAL CERTIFICATION

Quantum Learning in Teaching (Q-LIT) Certification for SOEd's students (developed based on the Quantum Learning System by the globally recognised and well-established Quantum Learning Network).



SOCIAL IMPACT AND COMMUNITY SERVICE

Projek BacaBaca works early literacy with children from underprivileged families.

The Night School Project works on continuous professional development of teachers of refugee learning centres.



PRACTICUM EXPLORATION: EMBRACING CHALLENGES AND MAKING AN IMPACT IN SUPPORTING CHILDREN'S CONTINUITY OF LEARNING DURING THE PANDEMIC

Dignity for Children Foundation

Yayasan Chow Kit



SOED'S 10TH BIRTHDAY: A DECADE OF PASSION AND TALENTS

A Celebration of SOEd's very own graduates, with SOEd giving out the inaugural Outstanding Alumni, Social Entrepreneur and Edu Innovator awards.



2024 ACEEU SDG INITIATIVE AWARD

Asia Pacific conferred by the Accreditation Council for Entrepreneurial and Engaged Universities (ACEEU), which honours outstanding contributions toward advancing the United Nations' Sustainable Development Goals (SDGs).



SUSTAINABILITY & CSR MALAYSIA AWARDS 2024

Youth Development & Empowerment Award, together with Mah Sing Foundation.



TIMES HIGHER EDUCATION 2024

Finalist, Outstanding Contribution to Regional Development

REFERENCE LIST

International Primary Curriculum

www.greatlearning.com/ipc

Ministry of Education Malaysia

www.moe.gov.my

Teach for Malaysia

www.teachformalaysia.org

Teach. Learn. Share TESL Malaysia

www.teslmalaysia.com

The Malaysian Association for Education

www.mae-malaysia.com

Malaysian English Language Teaching Association

www.melta.org.my

National Curriculum of England and Wales

www.education.gov.uk

<https://www.forbes.com/sites/danielnewman/2017/07/18/top-6-digital-transformation-trends-in-education/#73b437212a9a>

<https://www.forbes.com/sites/theyec/2018/10/19/how-the-fourth-industrial-revolution-is-impacting-the-future-of-work/#10bae5ed65a7>

<https://www.teachthought.com/the-future-of-learning/13-likely-realities-the-future-learning/>

<https://www.the-possible.com/future-of-education-digital-campus-learning-Teaching>

<https://elearningindustry.com/9-things-shape-future-of-education-learning-20-years>

<https://www.relocatemagazine.com/articles/education-schools-relocate-global-international-guide-education-in-the-fourth-industrial-revolution>

https://www3.weforum.org/docs/WEF_Schools_of_the_Future_Report_2019.pdf

GLOBAL CONNECTIONS



OVER **200**
UNIVERSITY PARTNERS

LEADERS

IN THE
GLOBAL
COMMUNITY



STUDENT EXCHANGE

SHORT TERM

MOBILITY



Taylor's is strongly committed to its mission of empowering the youth of the world through education, so that they may take their productive places as leaders in the global community.

As one of Malaysia's oldest, most successful and reputable private education institutions, Taylor's provides quality education and exposes students to the vast possibilities that await them beyond the classroom walls.

Through its partnerships with international universities and industry members, Taylor's is committed to providing an outstanding educational experience, guiding and helping students realise their potential to obtain a world-class qualification that meets the requirements of a dynamic, global marketplace.

GLOBAL EXCHANGE EXPERIENCES

SCAN TO
LEARN MORE

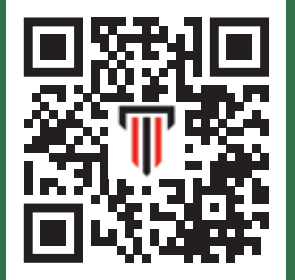

Are you eager to become a global citizen, broaden your horizons, and enrich your international perspective? Taylor's Global Mobility Programme provides students with the opportunity to widen their international exposure allowing students to gain new knowledge and skills in an area that is of interest to them thus benefiting from a multi-disciplinary learning environment and give their Taylor's degree an international edge.

TAYLOR'SPHERE CONNECTIONS & SUPPORT

RESEARCH AND TECHNOLOGY INNOVATION

Education at Taylor's is purpose-led and impact-driven, and was designed to align your passion, purpose, and profession. To achieve this, Taylor's established laboratories, known as Impact Labs which are solution-focused teams of academics, professional staff, practitioners and students with common purpose and are committed to work together to make progress on societal problems guided by United Nations Sustainable Development Goals (UN SDG).

TAYLOR'S IMPACT LABS PLAYS A CRUCIAL ROLE IN ELEVATING THE CAPABILITIES OF OUR FACULTY MEMBERS THROUGH VARIOUS TRAINING ACTIVITIES AND TECHNOLOGY, MAKING US WORLD-CLASS.



BACHELOR OF EDUCATION (HONS)

3-Year
Programme

KPT/JPS (R2/144/6/0005) (MQA/FA2073) 02/28

INTAKE: FEBRUARY, APRIL & SEPTEMBER

The Bachelor of Education (Hons) programme at Taylor's University instils sound practical and professional knowledge, skills and predispositions of classroom teaching based on a philosophical, theoretical and conceptual understanding of education.

Primary Core	University Core
<p>Year 1</p> <ul style="list-style-type: none"> Philosophy and Curriculum Design Education, School and Society Teaching and Managing Diverse Learners in the Classroom Learning, Assessment and Feedback <p>Year 2</p> <ul style="list-style-type: none"> Professional Practice 1 (PP1) Professional Practice 2 (PP2) <p>Year 3</p> <ul style="list-style-type: none"> New Pedagogies – Digital Tools and Resources The Reflective Practitioner: Teachers Investigate Their Work Action Research Project (*) Theory into Practice (*) <p>Specialisation:</p> <p>Option 1: Primary Education</p> <p>Year 1:</p> <ul style="list-style-type: none"> Teaching Language Arts Teaching Primary School English Language Language Use and Society Number & Algebra <p>Year 2:</p> <ul style="list-style-type: none"> Measurement & Geometry Statistics Science - Systems and Cycles Science - Energy and Interactions <p>Year 3:</p> <ul style="list-style-type: none"> Nature of Science <p>Option 2: Teaching of English</p> <p>Year 1:</p> <ul style="list-style-type: none"> Academic Reading & Writing ELT Methodology Introduction to Applied Linguistics I Introduction to Applied Linguistics II (*) <p>Year 2:</p> <ul style="list-style-type: none"> Introduction to Creative Writing Language, Culture & Society Materials Development in ELT <p>Year 3:</p> <ul style="list-style-type: none"> Recent Developments in ELT Capstone Project <p>Option 3: Early Childhood Education</p> <p>Year 1:</p> <ul style="list-style-type: none"> Promoting Children's Wellbeing Early Science and Numeracy Literacy and Language Development Managing Behaviour and Safety Advancing Play and Learning <p>Year 2:</p> <ul style="list-style-type: none"> Introduction to Human Nutrition <p>Year 3:</p> <ul style="list-style-type: none"> Inclusive Education Entrepreneurship & Small Business Capstone Project <p>Option 4: Special Educational Needs</p> <p>Year 1:</p> <ul style="list-style-type: none"> Introduction to Children with Special Educational Needs Supporting Children with Specific Learning Difficulties <p>Year 2:</p> <ul style="list-style-type: none"> Policy and Legislative Framework on Special Education Assessment and Intervention for Children with Special Educational Needs Managing Behaviour and Safety <p>Year 3:</p> <ul style="list-style-type: none"> Behavioural Management in Special Education Inclusive Education BUS60304 Entrepreneurship & Small Business Capstone Project 	<ul style="list-style-type: none"> Social Innovation Project Falsafah dan Isu Semasa Emotional Intelligence in Action (EI) Kursus Integriti dan Antirasuah (KIAR) Penghayatan Etika dan Peradaban / Bahasa Melayu Komunikasi 2 <p>*Students are requested to take Bahasa Kebangsaan A if they do not obtain a Credit for Bahasa Malaysia in SPM.</p> <p>12 Credit Hours</p>
	<p>Complementary Studies</p> <p>Choose ONE (1) of the below packages:</p> <p>Minor</p> <p>Choose any Minor package* offered by Taylor's University. Refer to the Flexible Education Guide for the list of Minor packages.</p> <p>and</p> <p>Free Elective Modules</p> <p>Choose any TWO (2) free electives** offered by Taylor's University. Refer to the Flexible Education Guide for the list of Free Electives.</p> <p>or</p> <p>Second Major</p> <p>Choose any Second Major package* offered by Taylor's University. Refer to the Flexible Education Guide for the list of Second Major packages.</p> <p>*Subject to availability</p> <p>**Meet min. module pre & co-requisite</p> <p>80 Credit Hours</p>

Note :

Primary Core + University Core + Minor = Min. 3 Years (120 Credit Hours)

Primary Core + University Core + Second Major = Min. 3.5 Years (148 Credit Hours)

Students must select their specialisation during enrolment as certain specialisations commence in Semester 1. Any change of specialisation during studies can impact study duration and fees.

SPECIALISATIONS

PRIMARY EDUCATION

This specialisation is for those who wish to pursue teaching or education-related careers at the primary level of schooling. The main focus of this specialisation is to develop homeroom teachers who are trained to teach English, Science, and Mathematics at the primary level. It enables students to learn and practise methods to address the learning needs of young learners using a variety of curricula.

Upon completion of this specialisation, graduates will be able to teach English, Science, and Mathematics, and develop content for these subjects at the primary level.

TEACHING OF ENGLISH

This specialisation is for those who aim to pursue the teaching of English as a career option or attain a better understanding of the English language. It provides an opportunity for students to learn how the English language is learned and taught, equipping them with practical knowledge and skills to teach a variety of English language programmes to linguistically and culturally diverse learners.

Upon completion of this specialisation, graduates will be able to teach English at various levels such as primary, secondary, and post-secondary.

EARLY CHILDHOOD EDUCATION

This specialisations is for those who wish to pursue teaching or education-related careers in early childhood education. The main focus of this specialisations is to develop early years teachers and caregivers. It enables students to learn and practise methods to address the learning needs of young learners using a variety of curricula.

Upon completion of this specialisation, students should be able to teach pre-schoolers and provide high-quality early childhood education and care to support children's transition to primary school.

SPECIAL EDUCATIONAL NEEDS

The special education needs specialisations is for those who wish to pursue teaching or education-related careers in special educational needs. The main focus of this specialisations is to develop special educational needs teachers and leaders. It enables students to learn and practise methods to address the learning needs and development of special educational needs learners using a variety of curricula.

Upon completion of this specialisation, students should be able to teach special educational needs students and provide high-quality special education and care to support children's learning and development.

WELCOME TO TAYLOR'sphere™

A well-balanced ecosystem and community that nurtures your intellect, creativity and practical wisdom to ensure you graduate future-proof and in demand.

Taylor'sphere aims to instil in every student the skills required to excel throughout their life journey and make a difference in the global community.

The components that make Taylor'sphere unique are the community of alumni, industry partners, academia and you, as well as resources and facilities that support your aspirations!

Community

Run by and in collaboration with a collective-wisdom community who are experienced, entrepreneurial, intellectual and forward-looking, Taylor'sphere paves your way to Rise With The Best™!



**Practitioners and
Industry Experts
& Leaders**



**Best-in-class
Lecturers**



Entrepreneurs



Alumni



Mentors



**Vibrant Global
Student
Community**

What Our Students Say



Bernard Yap
American Degree Transfer Program (Computer Science major)

My most impactful experience at Taylor's is working with mentors at Taylor's Me.reka Makerspace (TMM), who provided me guidance, free resources, and tools to build Pinky the Umbrella Borrowing Machine, inspired by a random act of kindness.



Jizen Loh
Bachelor of Mass Communication (Honours) in Public Relations and Marketing

My achievements in fencing got me Taylor's Sports Scholarship, for which I'm truly grateful. At Taylor's, I was able to fulfil my vision of creating affordable quality niche sports goods by collaborating with my peers and becoming an entrepreneur.



Zara Basyirah
Bachelor of Software Engineering (Honours)

At Taylor's, I led projects focusing on education equality and mental health. My lecturer even gave me the opportunity to lead a project hosting high school students for STEM exploration. Learning leadership skills helped me overcome challenges in leading my startup.

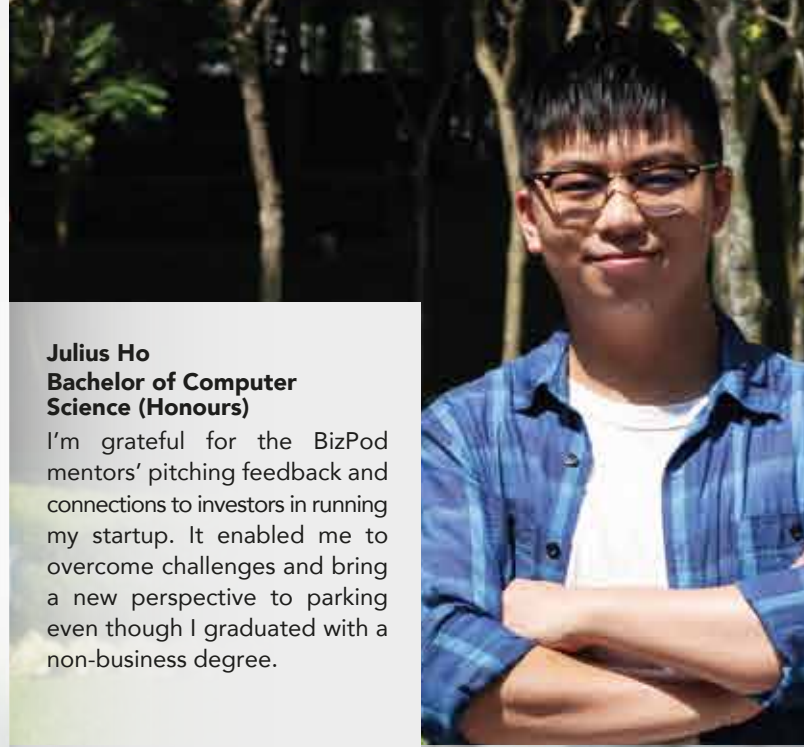

Julius Ho
Bachelor of Computer Science (Honours)

I'm grateful for the BizPod mentors' pitching feedback and connections to investors in running my startup. It enabled me to overcome challenges and bring a new perspective to parking even though I graduated with a non-business degree.



Shahmala Rani
Bachelor of Actuarial Studies (Honours)

I'm grateful for the many opportunities to learn in various fields – from being a RISERS Ambassador to discovering my passion for teaching through Peer Assisted Learning (PALS), to balancing my role as a national karate athlete.

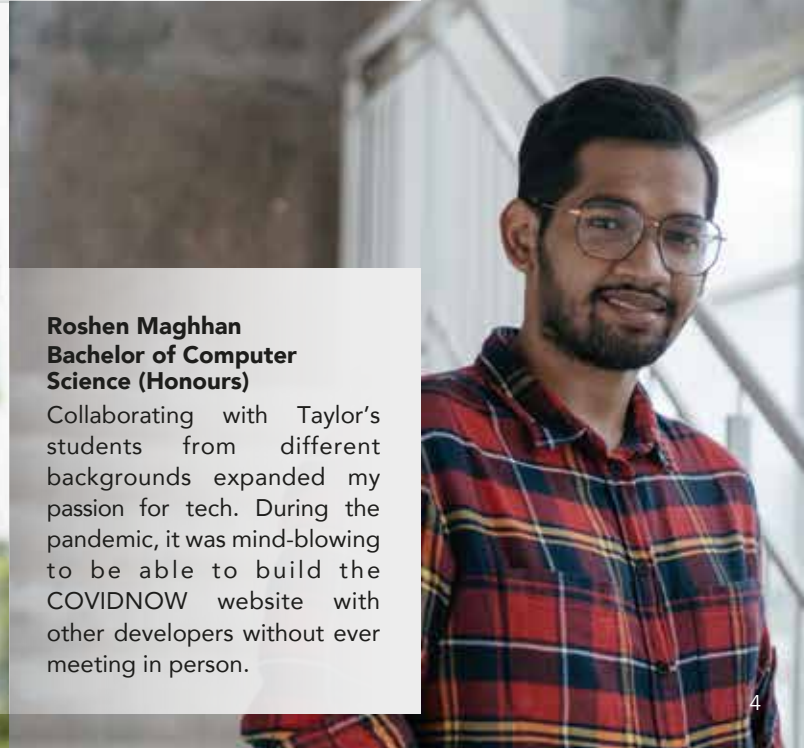

Roshen Maghhan
Bachelor of Computer Science (Honours)

Collaborating with Taylor's students from different backgrounds expanded my passion for tech. During the pandemic, it was mind-blowing to be able to build the COVIDNOW website with other developers without ever meeting in person.

GRADUATE IN
DEMAND WITH

TAYLOR'sphere™

Taylor'sphere is equipped with state-of-the-art and modern facilities, resources as well as flexible curriculums that can be customised to empower your aspirations and learning experience.

Facilities

Klang River

Engineering

Taylor's College

Taylor's Univ
Sdn Bhd

LT21



BizPod

A line-up of experienced lecturers and entrepreneurs are on hand to guide you through the maze and challenges - from ideating to growing your very own business startup.



VORTEX (Virtual Online Future Technology and Extended Reality)

Taylor's University's first XR lab to enhance virtual and immersive learning in an extended reality environment.



Taylor's Career Services Centre
Enhance your employment opportunities with our dedicated team of counsellors.



Taylor's Makerspace

With academicians, industry partners and entrepreneurial communities as your guide, TMM helps you turn your idea into reality!



Are you ready to Rise With The Best™
with Taylor'sphere?

Features



Life Skills Modules

The incorporation of Emotional Intelligence into the syllabus enables you to rise to challenges and uncertainties in the world.



First Year Learning and Mentoring (FLAME)

As a first year student, you will be assigned a Mentor to help you transition from school life to the university environment.



Multidisciplinary Learning Experiences (MLE)

Enjoy opportunities to work with peers from multi-disciplines to create change in society.

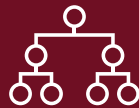

Taylor's Curriculum Framework

A holistic educational experience that gives you the flexibility to mix and match modules for a broader scope of learning, and future-proofs you with an additional certification, the Graduate Capabilities Attainment Statement, to boost your career opportunities.



Real-world Experiences

Boost your resume with real-life experiences, internship placements or work-based learning with industry partners.



SHINE Award

For your appreciation of and contribution to society, you could be rewarded with a SHINE Award.



Research & Enterprise

Flagship research programmes, industry-leading research centres, and qualified expertise to achieve balanced excellence in teaching and learning.



TEACHING & LEARNING SUPPORT



TEACHING & EDUCATIONAL DEVELOPMENT (TED)

Teaching and Educational Development (TED) at Centre For Future Learning is an award-winning department that supports the work of academic staff to create excellence in teaching through practice, development, and innovation.

TED offers workshops and seminars that address a range of timely topics associated with teaching, learning and technology in higher education.



E-LEARNING ACADEMY (eLA)

eLA's task is to help our academic staff effectively implement the use of technology in ensuring our students learning journey is seamless enabling them to learn in a collaborative, self-directed and personalised manner, anytime and anywhere.

Academics are recommended to utilise technology and tools such as ReWIND videos, Zoom, Microsoft Teams meeting, Google Classroom, Screencast-O-Matic, to name a few.

Despite the unprecedented challenges, eLA is here to support Taylor's academics and students to continuously learn and teach via online modalities.



ACADEMIC ADVISORY

Centre for Academic Programme Management (CAPM) works with all academic faculties in providing necessary academic support to students so as to ensure they graduate on time. CAPM has mechanisms in place to keep track of students and intervene where need be.

FLAME (First Year Learning and Mentoring) is Taylor's signature mentoring programme developed to assist newly enrolled First-Year students to settle into University & College life and study, gearing them towards achieving their personal learning goals.



TAYLOR'S CURRICULUM FRAMEWORK 2.0 (TCF 2.0)

At Taylor's, we future-proof you with a broader set of graduate capabilities beyond academic knowledge. We focus on a balanced set of attainment as you graduate.

The core purpose of TCF2.0 is for you to attain:



AN UNCONVENTIONAL FRAMEWORK DESIGNED TO FUTURE-PROOF YOU

Taylor's graduates stand out from others as they are equipped with well-rounded skills through numerous enriched and immersive learning experiences supported by various new initiatives.

1

GRADUATE WITH THE ACQUISITION OF THE 8 TAYLOR'S GRADUATE CAPABILITIES (TGCs)

The TGCs bring out the best in you. Capabilities learned and acquired will be highly valuable for employability in the Fourth Industrial Revolution (4IR).



TGC 1

Discipline Specific Knowledge



TGC 3

Lifelong Learning



TGC 5

Personal Competencies



TGC 7

Entrepreneurialism



TGC 2

Critical Thinking, Problem Solving & Creative Thinking Skills



TGC 4

Communication Skills



TGC 6

Social Competencies



TGC 8

Global Perspectives

2

STAND OUT WITH A GRADUATE CAPABILITIES ATTAINMENT STATEMENT

Students can showcase their extra effort to develop their graduate capabilities, and their contribution to society using their graduate capabilities to their potential employers

Employers can make a more informed decision during hiring

3

GET RECOGNISED WITH A SHINE AWARD IN CONTRIBUTING TO SOCIETY



Impactful Social Responsibility



Relationship Building and Networking



Teamwork and Collaboration



Personal Achievements



Cultural Adaptation and Appreciation

Rise With The Best

EMPLOYABILITY ASSURED

55% OF BACHELOR DEGREE HOLDERS ARE UNEMPLOYED. ALMOST NONE FROM TAYLOR'S.



97% of UG grads get hired within 6 months and they command 28% higher in average salary (40% higher for International versus Malaysian students)



Top 1% in the world and No.1 in Malaysia for Employer Reputation based on QS World University Rankings 2020 among Private Universities in Malaysia

TCF 2.0 INITIATIVES

MIX & MATCH MODULES BY COMPLEMENTING YOUR PRIMARY MAJOR WITH

Free Electives

Minor

2nd Major

Extension

Master Degree Level Modules (New)

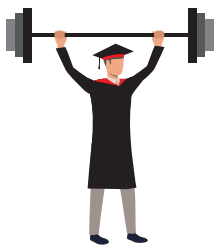

GET ASSESSED WITH WEIGHTED CGPA THAT EMPHASISES ON YOUR MOST RECENT PERFORMANCE AT THE TIME OF GRADUATION



CLASSROOM TO BOARDROOM OPPORTUNITIES THROUGH INNOFEST, THE SETUP, INDUSTRY IMMERSION PROJECTS



OUT-OF-CLASSROOM LEARNING THROUGH TAYLOR'S ME.REKA MAKERSPACE



GAIN SELF-DIRECTED LEARNING SKILLS FOR LIFE-LONG LEARNING THROUGH INDEPENDENT LEARNING WEEK



INSTILL ENTREPRENEURIALISM SKILLS TO SOLVE REAL WORLD ISSUES THROUGH U4 SOCIAL INNOVATION PROJECT

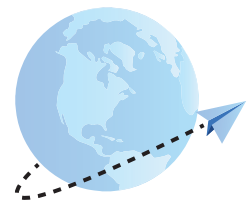

BUILD RESILIENCE, GLOBAL PERSPECTIVES AND CULTURAL ADAPTIVITY THROUGH STUDENT EXCHANGE PROGRAMME

ENGAGE WITH FUTURE EMPLOYERS DURING THE PROFESSIONAL DEVELOPMENT WEEK





FLEXIBLE STUDY COMPONENTS

Complement your primary major with related or unrelated fields from the same or different course through free electives, extension, minor, or a second major.

► LIST OF MINORS

- Accounting
- Advertising
- Broadcasting
- Business Analytics
- Chinese Language
- Coding
- Construction Management
- Creative Media Design
- Culinary Arts
- Culinary Science
- Design and Manufacturing
- Education
- Energy and Sustainability Engineering
- Entrepreneurship
- Event Management
- Finance
- FinTech
- Food Science
- Food & Beverage Business Development
- Health Science
- Heating, Ventilation and Air Conditioning (HVAC)
- IC Design and Embedded Systems
- International Business
- Journalism
- Korean Language
- Management
- Marketing
- Mass Communication
- Mechanical Design
- Mobile Technology
- Natural Sciences
- Nutrition
- Performing Arts
- Pharmaceutical Industrial Practice
- Pharmacology
- Power and Energy Systems
- Process Integration and Unit Operation
- Project Management
- Psychology
- Public Relations
- Robotic Design
- Travel and Leisure Management
- Web Technology

► LIST OF EXTENSIONS

- Advanced Pharmaceutical Industrial Practice
- Blockchain
- Cloud Computing
- Convention and Hospitality Management
- Corporate Law
- Cyber Security
- Data Science
- Design Exploration and Practice
- Digital Marketing
- Digital Media
- Gastronomy
- Heritage and Conservation
- International and Private Law
- Internet Technologies
- Mobile Computing
- Nutrition & Food Analysis
- Patisserie
- Sustainable Design

► LIST OF 2ND MAJORS

- Advertising
- Broadcasting
- Creative Media Design
- Education
- Information Technology
- Mass Communication
- Psychology
- Public Relations

► LIST OF ELECTIVES (ARTS, HUMANITIES & SOCIAL SCIENCE)

- Advertising Design And Execution
- Advertising Principles
- Alternative Dispute Resolution
- Applied Econometrics
- Audience Studies
- Biological Science (with Lab)
- Broadcast Performance
- Broadcasting Principles
- Calculus 1
- Chinese Language 1
- Cognitive Psychology
- Communication Theory
- Counselling: Basic Theories and Skills
- Creative Copywriting
- Creative Writing
- Crisis Management
- Destination Geography & Analysis
- Developmental Psychology
- Digital Storytelling and Production
- Education, School and Society
- Family Psychology
- Financial Public Relations
- Food Sociology
- Foundations of Acting
- Fundamental Mechanics of Filmmaking
- Fundamental of Music Theory I
- Fundamental of Vocal Performance
- General Chemistry (with lab)
- Group Dynamics
- Intercultural Communication
- Introduction to Creative Writing
- Introduction to Dance and Creative Processes
- Introduction to Mass Communication
- Introduction to Psychology
- Korean 1
- Language Use and Society
- Learning and Motivation
- Learning, Assessment and Feedback
- Measurement & Geometry
- Media Strategy
- Media Writing
- Microeconomics
- New Pedagogies – Digital Tools and Resources
- Newspaper and Magazine Production
- Number & Algebra
- Organisational Communication
- Philosophy and Curriculum Design
- Photo Journalism
- Print News Reporting
- Promotional Writing
- Public Relations Principles
- Publicity and Media Relations
- Radio and TV Production
- Radio and TV Reporting
- Reporting For New Media
- Science - Energy and Interactions
- Science - Systems and Cycles
- Social Entrepreneurship and Ethics
- Social Psychology
- Statistics
- Teaching and Managing Diverse Learners in the Classroom
- Teaching Language Arts
- Teaching Primary School English Language
- The Reflective Practitioner: Teachers Investigate Their Work
- Tourism Economics
- Visual Communication
- World Languages
- Writing For Broadcast

► LIST OF ELECTIVES (BUSINESS, SERVICE & MANAGEMENT)

- Bank Management
- Beverage Management
- Brand Management
- Business Consulting
- Business Ethics and Values
- Company Law in Malaysia
- Conventions and Meetings Management
- Data & Media Analysis for Tourism
- Design Thinking
- Entrepreneurship and Small Business
- Ethics and Corporate Governance
- Event and Tourism Risk Management
- Event Sponsorship and Funding
- Events and Entertainment
- Events Project Management
- Exhibition Management
- Financial Markets
- Food Business Management
- Food Media
- Food Trends and Products Innovation
- Futures and Options
- Human Resource Management
- Introduction to Accounting
- Introduction To Family Business
- Introduction to Finance
- Introduction to International Business
- Introduction to Management
- Islamic Banking and Finance
- Leadership and Change Management
- Malaysian Taxation
- Marketing Analytics
- Negotiation Skills for Project Management
- Personal Financial Planning
- Portfolio Management
- Principles of Culinary
- Principles of Marketing
- Principles of Pastry and Baking
- Principles of Restaurant Operation
- Production and Operations Management
- Project Communication and Stakeholder Management
- Project Leadership
- Project Management Fundamentals
- Project Time and Cost Management
- Risk Management
- Risk Management for Project
- Rules and Regulations of Futures and Options
- Service Operation Management
- Supply Chain Management
- Understanding Entrepreneurialism
- Wealth Management

► LIST OF ELECTIVES (SCIENCE, TECHNOLOGY & SOCIETY)

- Advanced Pharmacy Practice
- Architecture History and Theory
- Architecture and Environment
- Building Construction and Materials
- CAD 2D
- Calculus
- Cell Biology
- Clinical Trial Management
- Computer Applications
- Construction Quantity Surveying
- Construction Supply Chain Management
- Contemporary Design Theories
- Data Mining
- Data Science Principles
- Database Systems
- Design Communication
- Design Principles
- Digital Photography and Imaging
- Event Technology for Entertainment
- Food Packaging and Labelling
- Food Safety and Sanitation
- Fundamental of Chemistry
- Fundamentals of Linear Algebra
- Furniture Design
- Holistic Approach to Health and Wellness
- Human Anatomy and Physiology
- Human Computer Interaction
- Illustration and Visual Narrative
- Industrial Pharmacy
- Intercultural Design
- International Pharmacy Practice
- Introduction to Biotechnology
- Introduction to Food Science and Nutrition
- Introduction to Human Nutrition
- Management Information Systems
- Managing Hospitality Business and Service Experience
- Materials And Finishes
- Mathematics of Finance
- Mobile Applications Development
- Introduction of Mobile Computing
- Object Oriented Programming
- Occupational Health and Safety Management
- Pharmaceutical Analysis
- Pharmaceutical Formulation and Development-I
- Principles of Life Sciences
- Principles of Organic Chemistry
- Programming
- Regulation of Pharmaceuticals
- Sensory Evaluation of Food
- Theories of Asian Architecture
- Typography
- Video and Sound Production
- Web Applications Programming
- Web Development Technologies
- Wireless Networks and Security

ACCOMMODATION

Where you choose to stay is important to ensure your success in college. Choose the right accommodation that provides the support, experience and environment for you to succeed.

At Taylor's Hostel, we are committed to provide more than just a place to live but more importantly a place where students can learn. Taylor's Hostel provides its residents with quality on-campus accommodation options located within a safe and conducive environment.

DISCOVER THE BEST STUDENT LIVING EXPERIENCE



Stay in a safe environment



Be supported emotionally, physically and socially



Gain greater personal growth



Achieve better academic outcomes



ACCOMMODATION OPTIONS

ON CAMPUS (U RESIDENCE & RUEMZ)

- Located in Taylor's Lakeside Campus
- Tastefully-furnished rooms
- Air-conditioned
- Wi-Fi access (regulated for educational learning)
- 24-hour security guard service with surveillance system
- Exclusive U Lounge with TV, music and games room
- Common kitchen with cooking facilities
- Coin-operated laundromat (Available in Syopz Mall)
- Gym with swimming pool (Available at separate fees)
- Helpdesk for enquiries
- On-site maintenance team
- 24-hour support via live-in housemasters
- Residents' Welfare Support
- Housekeeping services

OFF CAMPUS

Off-campus accommodations are located conveniently close to Taylor's Lakeside Campus and are managed by panel operators. They offer basic amenities including Wi-Fi access and housekeeping to ensure your student life is hassle-free.



FOR INFORMATION & BOOKINGS

03 5631 3400

SCHOLARSHIPS AND BURSARIES

UNDERGRADUATE

2025

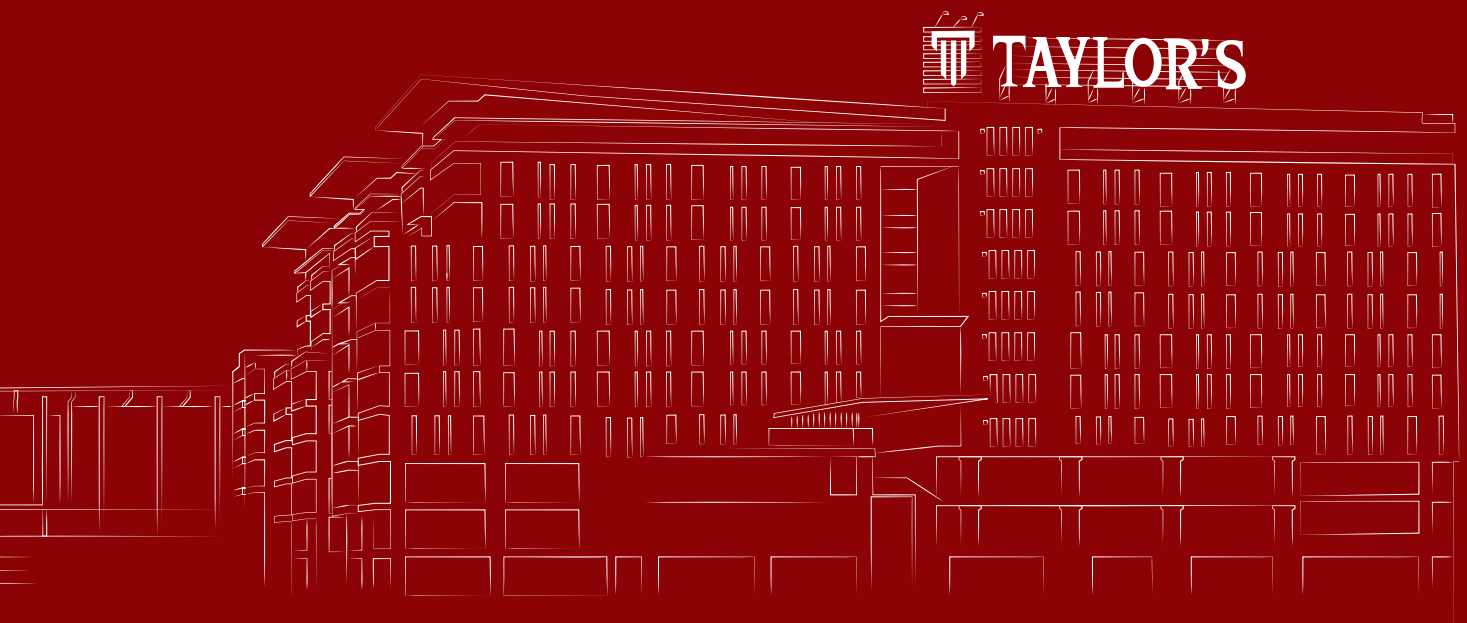

TAYLOR'S

WELCOME TO **TAYLOR'sphere**TM

It's our well-balanced ecosystem and community where alumni, industry partners, educators, resources, and facilities all come together to support your aspirations!

We nurture your intellect, creativity, and practical wisdom to ensure you graduate with a purpose, ready to make a difference.

● *Community*

Run by and in collaboration with a collective-wisdom community who are experienced, entrepreneurial, intellectual and forward-looking, Taylor'sphere paves your way to Rise With The BestTM!



**Practitioners,
Industry Experts
& Leaders**



**Best-in-class
Lecturers**



Entrepreneurs



Alumni



Mentors



**Vibrant Global
Student
Community**

TABLE OF CONTENTS

What Our Scholars Say	04
Advantages of Being a Scholar	05
Introduction to Financial Aid	06
Financial Aid Important Information	07
Taylor's College Excellence Award	08
Taylor's University Excellence Award	09
Taylor's College Scholarships	10
Taylor's University Scholarships	16
Taylor's College/University Bursaries	21
Frequently Asked Questions	22
Terms and Conditions	23

WHAT OUR SCHOLARS SAY

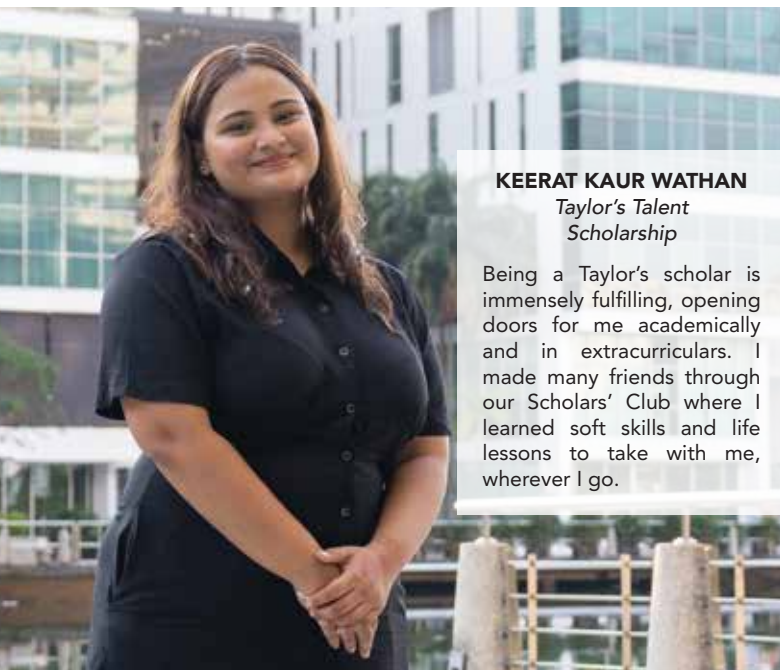

KEERAT KAUR WATHAN
*Taylor's Talent
Scholarship*

Being a Taylor's scholar is immensely fulfilling, opening doors for me academically and in extracurriculars. I made many friends through our Scholars' Club where I learned soft skills and life lessons to take with me, wherever I go.



EMIR RUSYAIDI
*Taylor's Sports
Scholarship*

My scholar's experience has granted me countless networking, financial, and social advantages in my journey as a Taylorian! It opened up unimaginable horizons in upskilling as well as meeting other high achievers in a well-knit community.



ELISHA PAULRAJ
*Taylor's Community
Scholarship*

My journey at Taylor's helped me grow with the confidence that I can rely on experienced individuals even when mistakes are made. The scholarship gave me exposure to diverse cultures and thinking, something I will always be thankful for!



GERMAINE HEW
*Taylor's World Class
Scholarship*

I led a fulfilling life at Taylor's with the scholarship, completing my internship at a prestigious company (Maybank), a stepping stone towards my career aspiration. Thankful too for the valuable experience through activities such as the Maybank Student Ambassador Programme!

ACHIEVEMENTS

EDUCATION EXCELLENCE RECOGNISED THROUGH OUR ACCOLADES



ADVANTAGES OF BEING A SCHOLAR

SCHOLAR'S CLUB

Join a distinguished community of high achievers like yourself. Collaborate with individuals who share your passions and aspirations, opening doors to potential collaborations, lifelong friendships, and invaluable networking opportunities that extend well beyond your scholarship years.



HIGHLY COMPETITIVE SELECTION

Our scholarships are awarded only to the most outstanding candidates. Being selected signifies your exceptional achievements and sets you apart from others. This recognition not only boosts your confidence but also serves as evidence of your exceptional abilities to future employers.



AMBASSADOR FOR THE INSTITUTION

Represents Taylor's values and achievements and acts as an exemplary student towards peers who upholds the values of Taylor'sphere.



ADDED VALUE FOR RESUME

Elevate your resume with the prestigious scholarship accolade. Make employers recognise your dedication to excellence, opening doors to coveted job positions, internships, and advanced educational pathways.



RECOGNITION AS A TOP-QUALITY GRADUATE

Our scholarship recipients gain the attention of industry leaders who acknowledge their potential. This recognition brings forth mentorship opportunities, access to influential networks, and potential collaborations.



FINANCIAL FREEDOM

Benefit from a waiver throughout the standard programme duration, allowing you to focus on your studies, embrace additional learning experiences, and even explore internships, fostering a holistic educational journey.



LIFE & LEADERSHIP SKILLS BUILDING

Engage in activities that foster life and leadership skills, vital for personal and professional success. Our scholars develop communication, teamwork, and problem-solving skills through hands-on experiences, ensuring you graduate not only academically competent but also well-equipped for real-world challenges.



INTRODUCTION TO FINANCIAL AID

Taylor's offers various forms of financial assistance, including scholarships, awards, and bursaries, which support our students throughout their studies.



SCHOLARSHIP

Scholarships are exclusively available to both Taylor's College and Taylor's University students for their chosen programme. Students may apply for the scholarship(s) at the point of enrolment should they meet the minimum eligibility and academic criteria. Shortlisted candidates will undergo assessments and interviews.



EXCELLENCE AWARD

The Excellence Award is a prestigious recognition of academic achievements. Students may attain the eligible quantum on a fast-track basis upon application based on their academic results.



BURSARY

The bursary is a form of discount that will be provided to students depending on their eligibility which will be advised by the appointed Counsellors at the point of enrolment.

FINANCIAL AID IMPORTANT INFORMATION

TAYLOR'S SCHOLARSHIP APPLICATION PROCESS

- Merit Scholarship • Talent Scholarship • Sports Scholarship • Community Scholarship
- PPE Exclusive Scholarship • Postgraduate High Achiever Scholarship
- ACCA Scholarship • Young Accountant Scholarship

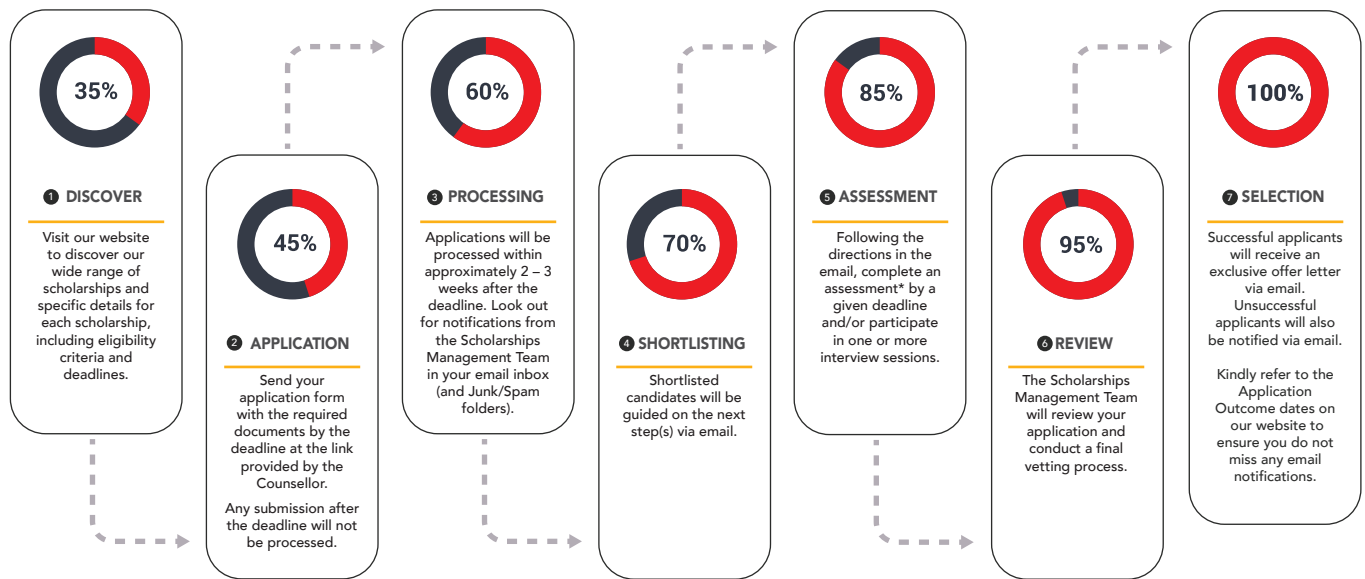

*Applicable to selected scholarship(s) only

Notes:

1. Should you meet the scholarship eligibility criteria, kindly reach out to the appointed Counsellors to obtain an application form.
2. Scholarships are only available for Malaysian and Taylor's Education Group (TEG) progression International students.
3. For International Students, kindly check with the appointed Counsellors on the available scholarships.

DEADLINES AND OUTCOME

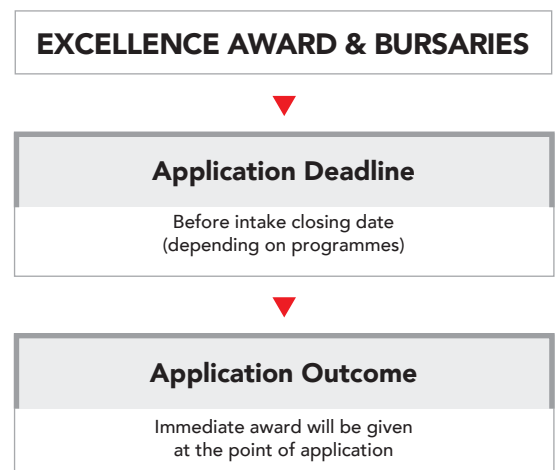
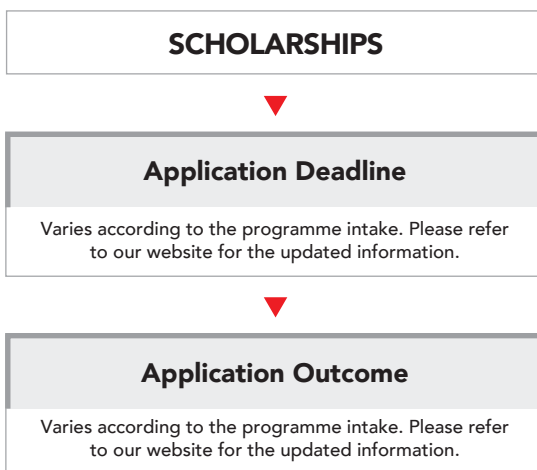

TAYLOR'S COLLEGE EXCELLENCE AWARD



PROGRAMME

Cambridge A Level/Australian Matriculation/Foundation/
Diploma/ACCA Foundation in Accountancy/ACCA

QUANTUM

AUSTRALIAN MATRICULATION (AUSMAT)

SPM	IGCSE	OSSC	UEC	Quantum
8A+ / 9 (A+, A, A-) and above	8A* / 9 (A*, A) and above	95% and above	12 pts & below	Up to RM 15,000
8 (A+, A, A-)	8 (A*, A)	90% - 94.99%		Up to RM 8,000
7 (A+, A, A-)	7 (A*, A)	88% - 89.99%	13 - 15 pts	Up to RM 6,000
6 (A+, A, A-)	6 (A*, A)	86% - 87.99%		Up to RM 5,000
5 (A+, A, A-)	5 (A*, A)	84% - 85.99%		Up to RM 4,000

CAMBRIDGE A LEVEL (CAL)

SPM	IGCSE	OSSC	UEC	Quantum	
				4 subjects	3 subjects
8A+ / 9 (A+, A, A-) and above	8A* / 9 (A*, A) and above	95% and above	12 pts & below	Up to RM 15,000	Up to RM 12,000
8 (A+, A, A-)	8 (A*, A)	90% - 94.99%		Up to RM 8,000	Up to RM 7,000
7 (A+, A, A-)	7 (A*, A)	86% - 89.99%	13 - 15 pts	Up to RM 6,000	Up to RM 5,000
6 (A+, A, A-)	6 (A*, A)	84% - 85.99%		Up to RM 5,000	Up to RM 4,000
5 (A+, A, A-)	5 (A*, A)			Up to RM 4,000	Up to RM 3,000

FOUNDATION

SPM	IGCSE	UEC	Quantum
8A+ / 9 (A+, A, A-) and above	8A* / 9 (A*, A) and above	12 pts & below	Up to RM 12,000
8 (A+, A, A-)	8 (A*, A)		Up to RM 7,000
7 (A+, A, A-)	7 (A*, A)	13 - 15 pts	Up to RM 6,000
6 (A+, A, A-)	6 (A*, A)		Up to RM 4,000
5 (A+, A, A-)	5 (A*, A)		Up to RM 2,000

ELIGIBILITY

General Criteria

- Applicable to Malaysian and International students holding results from recognised institutions in Malaysia OR;
- Applicable to Malaysian students holding results from recognised overseas institutions for selected qualifications (e.g.: IGCSE/A Level/IB)
- Forecast/trial/actual results
- Applicable for full-time programmes only

DIPLOMA [Applicable for selected Diplomas only]

SPM	IGCSE	Quantum
8A+ / 9 (A+, A, A-) and above	8A* / 9 (A*, A) and above	Up to RM 10,000
8 (A+, A, A-)	8 (A*, A)	Up to RM 8,000
7 (A+, A, A-)	7 (A*, A)	Up to RM 7,000
6 (A+, A, A-)	6 (A*, A)	Up to RM 6,000
5 (A+, A, A-)	5 (A*, A)	Up to RM 5,000
4 (A+, A, A-)	4 (A*, A)	Up to RM 4,000
3 (A+, A, A-)	3 (A*, A)	Up to RM 3,000

ACCA FOUNDATION IN ACCOUNTANCY (ACCA FIA)

SPM	IGCSE	Quantum
9 (A+, A, A-) and above	9 (A*, A) and above	Up to RM 7,000
8 (A+, A, A-)	8 (A*, A)	Up to RM 6,000
7 (A+, A, A-)	7 (A*, A)	Up to RM 5,000
6 (A+, A, A-)	6 (A*, A)	Up to RM 4,000
5 (A+, A, A-)	5 (A*, A)	Up to RM 3,000

ACCA

STPM	ACCA FIA	UEC	Diploma / Foundation / Matriculation	A Level	ATAR / OSSD / MUFY	IB	Quantum
≥ CGPA 3.55	≥ 90	≤ 9 pts	≥ CGPA 3.60	AAA/AAB	≥ 85 (%)	≥ 33	Up to 35%
≥ CGPA 3.22	≥ 80	10 - 12 pts	≥ CGPA 3.40	ABB/AAC	≥ 80 (%)	≥ 29	Up to 25%
≥ CGPA 3.00	≥ 70	13 - 20 pts	≥ CGPA 3.20	BBB/ABC	≥ 70 (%)	≥ 25	Up to 15%

Notes:

1. UEC points are calculated based on the best **five (5)** subjects. This applies to all levels of study where UEC qualification is considered for the award.
2. OSSC/OSSD percentages are calculated based on the best **six (6)** subjects: Year 11 subjects for OSSC and Year 12 subjects for OSSD, including compulsory subjects. This applies to all levels of study where OSSC/OSSD qualification is considered for the award.

TAYLOR'S UNIVERSITY EXCELLENCE AWARD



PROGRAMME

ADP/Diploma/Advanced Diploma/Degree

QUANTUM

ADP

SPM	IGCSE	OSSD	UEC	Quantum
8A+ / 9 (A+, A, A-) and above	8A* / 9 (A*, A) and above	95% and above	12 pts & below	Up to RM 15,000
8 (A+, A, A-)	8 (A*, A)	90% - 94.99%		Up to RM 8,000
7 (A+, A, A-)	7 (A*, A)	86% - 89.99%	13 - 15 pts	Up to RM 6,000
6 (A+, A, A-)	6 (A*, A)	84% - 85.99%		Up to RM 5,000
5 (A+, A, A-)	5 (A*, A)			Up to RM 4,000

DIPLOMA [Applicable for selected Diplomas only]

SPM	IGCSE	Quantum
8A+ / 9 (A+, A, A-) and above	8A* / 9 (A*, A) and above	Up to RM 10,000
8 (A+, A, A-)	8 (A*, A)	Up to RM 8,000
7 (A+, A, A-)	7 (A*, A)	Up to RM 7,000
6 (A+, A, A-)	6 (A*, A)	Up to RM 6,000
5 (A+, A, A-)	5 (A*, A)	Up to RM 5,000
4 (A+, A, A-)	4 (A*, A)	Up to RM 4,000
3 (A+, A, A-)	3 (A*, A)	Up to RM 3,000

ELIGIBILITY

General Criteria

- Applicable to Malaysian and International students holding results from recognised institutions in Malaysia OR;
- Applicable to Malaysian students holding results from recognised overseas institutions for selected qualifications (e.g.: IGCSE/A Level/IB/OSSD)
- Forecast/trial/actual results

ADVANCED DIPLOMA

Diploma	Quantum
≥ CGPA 3.70	Up to RM 12,000
≥ CGPA 3.30	Up to RM 6,000

DEGREE [For all Bachelor programmes except FHMS programmes]

STPM	UEC	Diploma / Foundation / Matriculation	A Level	ATAR / OSSD / MUFY	IB	Quantum
≥ CGPA 3.55	5 pts	≥ CGPA 3.80	AAA	≥ 90 (%)	≥ 33	Up to RM 13,000 Per Year
≥ CGPA 3.22	6 - 12 pts	≥ CGPA 3.60	AAB / ABB AAC	≥ 80 (%)	≥ 29	Up to RM 7,000 Per Year

DEGREE [For all FHMS programmes]

STPM	UEC	Diploma / Foundation / Matriculation	A Level	ATAR / OSSD / MUFY	IB	Quantum
≥ CGPA 3.70	5 pts	≥ CGPA 3.90	AAA	≥ 90 (%)	≥ 33	Up to RM 13,000 Per Year
≥ CGPA 3.50	6 - 12 pts	≥ CGPA 3.70	AAB	≥ 80 (%)	≥ 29	Up to RM 7,000 Per Year

For further details on the Faculty of Health & Medical Sciences (FHMS) programmes, kindly reach out to the education counsellors.

Notes:

1. UEC points are calculated based on the best **five (5)** subjects. This applies to all levels of study where UEC qualification is considered for the award.
2. OSSD percentages are calculated based on the best **six (6)** subjects in Year 12, including compulsory subjects. This applies to all levels of study where OSSD qualification is considered for the award.

TAYLOR'S COLLEGE MERIT SCHOLARSHIP

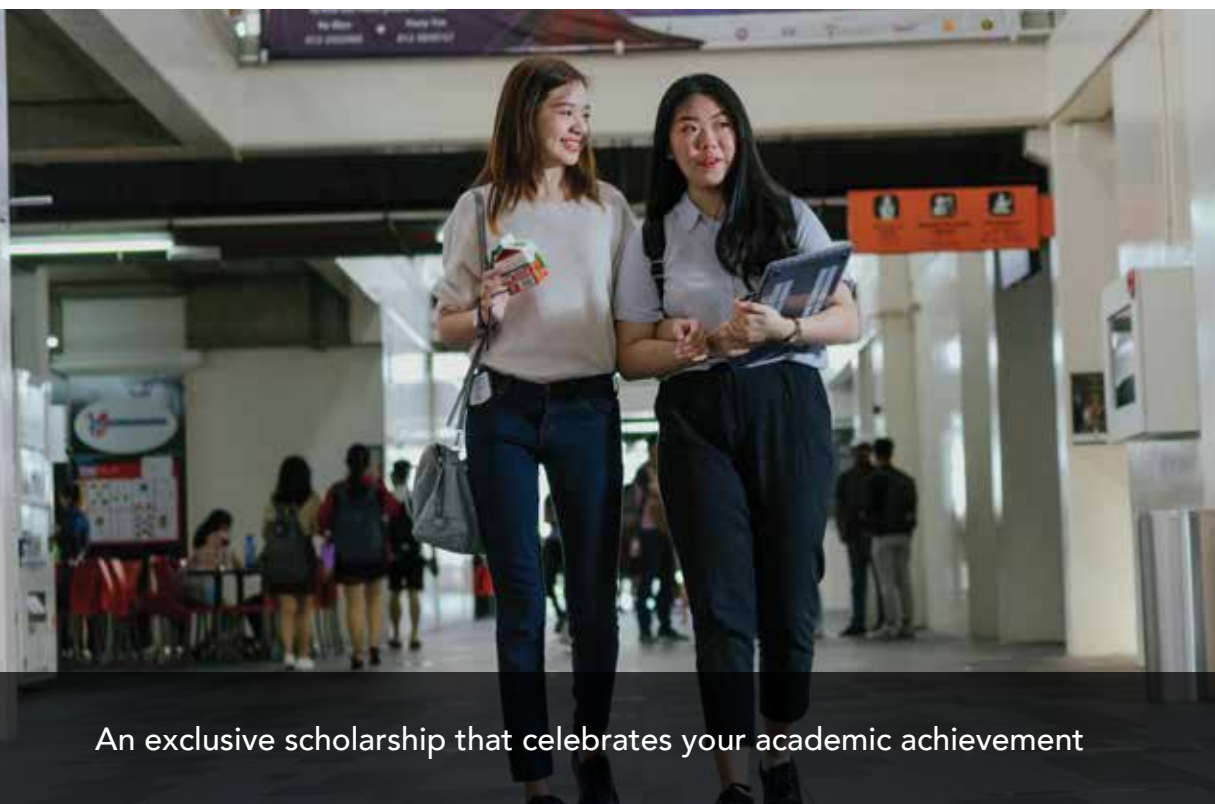

An exclusive scholarship that celebrates your academic achievement

Application : Up to the scholarship application deadline

PROGRAMME

Cambridge A Level/Australian Matriculation/Foundation/Diploma*

ELIGIBILITY

General Criteria

- Applicable to Malaysian students holding results from recognised institutions in Malaysia OR;
- Applicable to Malaysian students holding results from recognised overseas institutions for selected qualifications (e.g.: IGCSE) OR;
- Applicable to International students from TEG schools only
- Letter of Offer (LOO) required at point of application
- Forecast/trial/actual results
- Achievements in competitions and positions held in clubs/societies/institutions/events will be evaluated based on level of participation

Academic Criteria

- SPM: Minimum 45 points
- IGCSE: Minimum 40 points
- UEC: Maximum 10 points in 5 subjects and must include minimum B4 in English or IELTS Band 6.0

ASSESSMENT

- Online Psychometric Test
- Interview

QUANTUM

- Full scholarship
- 70% tuition fee waiver
- 50% tuition fee waiver

Points	5	4	3
SPM	A+	A	A-
IGCSE	A*	A	B

*Applicable for selected Diplomas only

Notes:

1. Assessment applicable for shortlisted candidates only
2. Quantum will be awarded at the discretion of the Scholarships Management

TAYLOR'S COLLEGE TALENT SCHOLARSHIP

A prestigious scholarship that nurtures and recognises your artistic and on-stage abilities

Application : Up to the scholarship application deadline

PROGRAMME

Cambridge A Level/Australian Matriculation/Foundation/Diploma*

ELIGIBILITY

General Criteria

- National-level participation in selected artistic or on-stage performance
- Applicable to Malaysian students holding results from recognised institutions in Malaysia OR;
- Applicable to Malaysian students holding results from recognised overseas institutions for selected qualifications (e.g.: IGCSE) OR;
- Applicable to International students from TEG schools only
- Letter of Offer (LOO) required at point of application
- Forecast/trial/actual results
- Achievements in competitions and positions held in clubs/societies/institutions/events will be evaluated based on level of participation

Academic Criteria

- SPM: Minimum 30 points
- IGCSE: Minimum 25 points
- UEC: Maximum 15 points in 5 subjects and must include minimum B4 in English or IELTS Band 6.0

**Applicable for selected Diplomas only*

Notes:

1. Assessment applicable for shortlisted candidates only
2. Quantum will be awarded at the discretion of the Scholarships Management

ASSESSMENT

- Live performance
- Interview

QUANTUM

- Full scholarship
- 70% tuition fee waiver
- 50% tuition fee waiver

Points	5	4	3	2
SPM	A+	A	A-	B+
IGCSE	A*	A	B	C

CONSIDERED TALENTS

- Musical Instruments (e.g.: Piano, Guitar, Violin)
- Dance
- Singing

TAYLOR'S COLLEGE SPORTS SCHOLARSHIP



An opportunity for the nation's sports heroes to study and battle among the best

Application : Up to the scholarship application deadline

PROGRAMME

Cambridge A Level/Australian Matriculation/Foundation/Diploma*

ELIGIBILITY

General Criteria

- National-level participation in selected sports competition(s)
- Applicable to Malaysian students holding results from recognised institutions in Malaysia OR;
- Applicable to Malaysian students holding results from recognised overseas institutions for selected qualifications (e.g.: IGCSE) OR;
- Applicable to International students from TEG schools only
- Letter of Offer (LOO) required at point of application
- Forecast/trial/actual results
- Achievements in competitions and positions held in clubs/societies/institutions/events will be evaluated based on level of participation
- To select any intake for the specific year only (non-transferable)

Academic Criteria

- Meet minimum programme entry requirements and maintain satisfactory results throughout standard programme duration

**Applicable for selected Diplomas only*

Notes:

1. Assessment applicable for shortlisted candidates only
2. Quantum will be awarded at the discretion of the Scholarships Management

ASSESSMENT

- Interview

QUANTUM

- Full scholarship
- 70% tuition fee waiver
- 50% tuition fee waiver

CONSIDERED SPORTS

- | | |
|-------------------|---------------|
| • Swimming | • Taekwondo |
| • Badminton | • Athletics |
| • Basketball | • Chess |
| • Table Tennis | • Tennis |
| • Futsal/Football | • Captainball |
| • Volleyball | • Karate |
| • Dodgeball | • Bowling |
| • Netball | • Squash |

TAYLOR'S COLLEGE COMMUNITY SCHOLARSHIP



A helping hand to bridge the gap between young talents
and the futures they envision

Application : Up to the scholarship application deadline

PROGRAMME

Cambridge A Level/Australian Matriculation/Foundation/Diploma*

ELIGIBILITY

General Criteria

- Applicable to Malaysian students holding results from recognised institutions in Malaysia OR;
- Applicable to Malaysian students holding results from recognised overseas institutions for selected qualifications (e.g.: IGCSE)
- Forecast/trial/actual results
- Achievements in competitions and positions held in clubs/societies/institutions/events will be evaluated based on level of participation
- Household income must be below RM5,000 per month
- Number of dependents & physical disability will be an additional consideration factor
- To select any intake for the specific year only (non-transferable)

Academic Criteria

- SPM: Minimum 30 points
- IGCSE: Minimum 25 points
- UEC: Maximum 15 points in 5 subjects and must include minimum B4 in English or IELTS Band 6.0

ASSESSMENT

- Interview

QUANTUM

- Full scholarship

Points	5	4	3	2
SPM	A+	A	A-	B+
IGCSE	A*	A	B	C

*Applicable for selected Diplomas only

Notes:

1. Assessment applicable for shortlisted candidates only
2. Quantum will be awarded at the discretion of the Scholarships Management

TAYLOR'S COLLEGE YOUNG ACCOUNTANT SCHOLARSHIP



An exclusive scholarship for students who want to take the fastest pathway to pursue a professional certificate in ACCA

Application : Up to the scholarship application deadline

PROGRAMME

ACCA Foundation in Accountancy (ACCA FIA)

ELIGIBILITY

General Criteria

- Applicable for full-time programme only
- Applicable to Malaysian students holding results from recognised institutions in Malaysia OR;
- Applicable to Malaysian students holding results from recognised overseas institutions for selected qualifications (e.g.: IGCSE)
- Letter of Offer (LOO) required at point of application
- Forecast/trial/actual results
- Achievements in competitions and positions held in clubs/societies/institutions/events will be evaluated based on level of participation
- Maintenance of pass required in all papers for the continuation of the scholarship

Academic Criteria

- SPM: 8As (A+, A, A-) and above
- IGCSE: 8As (A*, A) and above

ASSESSMENT

- Written Assessment
- Online Psychometric Test
- Interview

QUANTUM

- 100% tuition fee waiver

Notes:

1. Assessment applicable for shortlisted candidates only
2. Quantum will be awarded at the discretion of the Scholarships Management

TAYLOR'S COLLEGE ACCA SCHOLARSHIP



An exclusive scholarship for students passionate about pursuing their professional accounting certificate

Application : Up to the scholarship application deadline

PROGRAMME

Association of Chartered Certified Accountants (ACCA)

ELIGIBILITY

General Criteria

- Applicable for full-time programme only
- Applicable to Malaysian students holding results from recognised institutions in Malaysia OR;
- Applicable to Malaysian students holding results from recognised overseas institutions for selected qualifications (e.g.: A Level/IB/OSSD)
- Letter of Offer (LOO) required at point of application
- Forecast/trial/actual results
- Achievements in competitions and positions held in clubs/societies/institutions/events will be evaluated based on level of participation
- Maintenance of pass required in all papers for the continuation of the scholarship
- Minimum 13 papers in ACCA
- Minimum 10 papers in ACCA (for ACCA FIA graduates only)

ASSESSMENT

- Written Assessment
- Interview

QUANTUM

- 100% tuition fee waiver
- 50% tuition fee waiver

Qualification	Academic Criteria	
	100% tuition fee waiver	50% tuition fee waiver
STPM	Minimum CGPA 3.33	Minimum CGPA 3.00
Foundation/ Diploma/ Matriculation	Minimum CGPA 3.50	Minimum CGPA 3.33
A Level	Minimum 13 points	Minimum 12 points
ATAR	Minimum 85%	Minimum 75%
OSSD/MUFY	Minimum 85%	
IB	Minimum 30 points	
ACCA FIA	Minimum 75%	
UEC	Maximum 10 points in 5 subjects and must include minimum B4 in English or IELTS Band 6.0	Maximum 13 points in 5 subjects and must include minimum B4 in English or IELTS Band 6.0

Points	5	4
A Level	A*/A	B

Notes:

1. Assessment applicable for shortlisted candidates only
2. Quantum will be awarded at the discretion of the Scholarships Management

TAYLOR'S UNIVERSITY MERIT SCHOLARSHIP

An exclusive scholarship that celebrates your academic achievement

Application : Up to the scholarship application deadline

PROGRAMME

ADP/Diploma*/Advanced Diploma/Degree

ELIGIBILITY

General Criteria

- Applicable to Malaysian students holding results from recognised institutions in Malaysia OR;
- Applicable to Malaysian students holding results from recognised overseas institutions for selected qualifications (e.g.: IGCSE/A Level/IB/OSSD) OR;
- Applicable to International students from TEG schools only
- Letter of Offer (LOO) required at point of application
- Forecast/trial/actual results
- Achievements in competitions and positions held in clubs/societies/institutions/events will be evaluated based on level of participation

Academic Criteria

- SPM: Minimum 45 points
- IGCSE: Minimum 40 points
- STPM: Minimum CGPA 3.75
- Foundation/Diploma/Matriculation: Minimum CGPA 3.80
- A Level: Minimum 15 points
- ATAR: Minimum 90%
- OSSD/MUFY: Minimum 90%
- IB: Minimum 30 points
- UEC: Maximum 10 points in 5 subjects and must include minimum B4 in English or IELTS Band 6.0

**Applicable for selected Diplomas only*

Notes:

1. Assessment applicable for shortlisted candidates only
2. Quantum will be awarded at the discretion of the Scholarships Management

ASSESSMENT

- Online Psychometric Test
- Interview

QUANTUM

- 70% tuition fee waiver
- 50% tuition fee waiver

Points	5	4	3
SPM	A+	A	A-
IGCSE	A*	A	B
A Level	A*/A	B	C

TAYLOR'S UNIVERSITY TALENT SCHOLARSHIP

A prestigious scholarship that nurtures and recognises your artistic and on-stage abilities

Application : Up to the scholarship application deadline

PROGRAMME

ADP/Diploma*/Advanced Diploma/Degree

ELIGIBILITY

General Criteria

- National-level participation in selected artistic or on-stage performance
- Applicable to Malaysian students holding results from recognised institutions in Malaysia OR;
- Applicable to Malaysian students holding results from recognised overseas institutions for selected qualifications (e.g.: IGCSE/A Level/IB/OSSD) OR;
- Applicable to International students from TEG schools only
- Letter of Offer (LOO) required at point of application
- Forecast/trial/actual results
- Achievements in competitions and positions held in clubs/societies/institutions/ events will be evaluated based on level of participation

Academic Criteria

- SPM: Minimum 30 points
- IGCSE: Minimum 25 points
- STPM: Minimum CGPA 3.00
- Foundation/Diploma/Matriculation: Minimum CGPA 3.30
- A Level: Minimum 10 points
- ATAR: Minimum 80%
- OSSD/MUFY: Minimum 80%
- IB: Minimum 25 points
- UEC: Maximum 15 points in 5 subjects and must include minimum B4 in English or IELTS Band 6.0

*Applicable for selected Diplomas only

Notes:

1. Assessment applicable for shortlisted candidates only
2. Quantum will be awarded at the discretion of the Scholarships Management

ASSESSMENT

- Live performance
- Interview

QUANTUM

- 70% tuition fee waiver
- 50% tuition fee waiver

Points	5	4	3	2
SPM	A+	A	A-	B+
IGCSE	A*	A	B	C
A Level	A*/A	B	C	

CONSIDERED TALENTS

- Musical Instruments (e.g.: Piano, Guitar, Violin)
- Dance
- Singing

TAYLOR'S UNIVERSITY SPORTS SCHOLARSHIP



An opportunity for the nation's sports heroes to study and battle among the best

Application : Up to the scholarship application deadline

PROGRAMME

ADP/Diploma*/Advanced Diploma/Degree

ELIGIBILITY

General Criteria

- National-level participation in selected sports competition(s)
- Applicable to Malaysian students holding results from recognised institutions in Malaysia OR;
- Applicable to Malaysian students holding results from recognised overseas institutions for selected qualifications (e.g.: IGCSE/A Level/IB/OSSD) OR;
- Applicable to International students from TEG schools only
- Letter of Offer (LOO) required at point of application
- Forecast/trial/actual results
- Achievements in competitions and positions held in clubs/societies/institutions/events will be evaluated based on level of participation
- To select any intake for the specific year only (non-transferable)

Academic Criteria

- Meet minimum programme entry requirements and maintain satisfactory results throughout standard programme duration

ASSESSMENT

- Interview

QUANTUM

- 70% tuition fee waiver
- 50% tuition fee waiver

CONSIDERED SPORTS

- | | |
|-------------------|---------------|
| • Swimming | • Taekwondo |
| • Badminton | • Athletics |
| • Basketball | • Chess |
| • Table Tennis | • Tennis |
| • Futsal/Football | • Captainball |
| • Volleyball | • Karate |
| • Dodgeball | • Bowling |
| • Netball | • Squash |

**Applicable for selected Diplomas only*

Notes:

1. Assessment applicable for shortlisted candidates only
2. Quantum will be awarded at the discretion of the Scholarships Management

TAYLOR'S UNIVERSITY COMMUNITY SCHOLARSHIP



A helping hand to bridge the gap between young talents
and the futures they envision

Application : Up to the scholarship application deadline

PROGRAMME

ADP/Diploma*/Advanced Diploma/Degree

ELIGIBILITY

General Criteria

- Applicable to Malaysian students holding results from recognised institutions in Malaysia OR;
- Applicable to Malaysian students holding results from recognised overseas institutions for selected qualifications (e.g.: IGCSE/A Level/IB/OSSD)
- Forecast/trial/actual results
- Achievements in competitions and positions held in clubs/societies/institutions/events will be evaluated based on level of participation
- Household income must be below RM5,000 per month
- Number of dependents & physical disability will be an additional consideration factor
- To select any intake for the specific year only (non-transferable)

Academic Criteria

- SPM: Minimum 30 points
- IGCSE: Minimum 25 points
- STPM: Minimum CGPA 3.00
- Foundation/Diploma/Matriculation: Minimum CGPA 3.30
- A Level: Minimum 10 points
- ATAR: Minimum 80%
- OSSD/MUFY: Minimum 80%
- IB: Minimum 25 points
- UEC: Maximum 15 points in 5 subjects and must include minimum B4 in English or IELTS Band 6.0

**Applicable for selected Diplomas only*

Notes:

1. Assessment applicable for shortlisted candidates only
2. Quantum will be awarded at the discretion of the Scholarships Management

ASSESSMENT

- Interview

QUANTUM

- Full scholarship

Points	5	4	3	2
SPM	A+	A	A-	B+
IGCSE	A*	A	B	C
A Level	A*/A	B	C	

TAYLOR'S UNIVERSITY

PPE EXCLUSIVE SCHOLARSHIP



Designed to support your ambition to shape policies, transform industries, and make a difference in societies

Application : Up to the scholarship application deadline

PROGRAMME

PPE: Bachelor in Philosophy, Politics, and Economics (Honours)

ELIGIBILITY

General Criteria

- Applicable to Malaysian students holding results from recognised institutions in Malaysia OR;
- Applicable to Malaysian students holding results from recognised overseas institutions for selected qualifications (e.g.: A Level/IB/OSSD) OR;
- Applicable to International students from TEG schools only
- Letter of Offer (LOO) required at point of application
- Forecast/trial/actual results
- Achievements in competitions and positions held in clubs/societies/institutions/events will be evaluated based on level of participation

Academic Criteria		
Qualification	100% tuition fee waiver	50% tuition fee waiver
STPM	Minimum CGPA 3.75	Minimum CGPA 3.50
Foundation/ Diploma/ Matriculation	Minimum CGPA 3.80	Minimum CGPA 3.60
A Level	Minimum 15 points (AAA)	Minimum 13 points (AAB/ABB/AAC)
ATAR	Minimum 90%	Minimum 80%
OSSD/MUFY	Minimum 90%	Minimum 80%
IB	Minimum 33 points	Minimum 29 points
UEC	Maximum 10 points in 5 subjects and must include minimum B4 in English or IELTS Band 6.0	Maximum 12 points in 5 subjects and must include minimum B4 in English or IELTS Band 6.0

ASSESSMENT

- Written Assessment
- Group Interview

QUANTUM

- 100% tuition fee waiver
- 50% tuition fee waiver

Points	5	4	3
A Level	A*/A	B	C

Notes:

1. Assessment applicable for shortlisted candidates only
2. Quantum will be awarded at the discretion of the Scholarships Management

TAYLOR'S COLLEGE/UNIVERSITY BURSARIES

TAYLOR'S EDUCATION GROUP (TEG) BURSARY

Progressed from Taylor's University/College/School

PROGRAMME

ACCA (Full-time)*/Advanced Diploma/Degree

ELIGIBILITY

General Criteria

- Progressed within 1 year of graduation date from Taylor's University/Taylor's College/TEG Schools
- Degree: Progressed from Taylor's University/Taylor's College TEG Schools into Taylor's University/Taylor's College
- Advanced Diploma & BCM Final Year 3: Progressed from eligible Taylor's University programme into Taylor's University Advanced Diploma/BCM Final Year 3
- ACCA (Full-time): Progressed from Taylor's College Pre-U/Foundation/ACCA FIA

Academic Criteria

- Meet minimum programme entry requirements

QUANTUM

Programme	Quantum
Degree & ACCA (Full-time*)	Up to RM8,000 tuition fee waiver
Advanced Diploma	Up to RM4,000 tuition fee waiver
BCM Final Year 3	Up to RM4,000 tuition fee waiver

**Application for ACCA 2.5/3 years duration of studies only*

TAYLOR'S EDUCATION GROUP (TEG) BURSARY

Progressed from Taylor's School

PROGRAMME

Foundation/Diploma/Pre-U/ADP

ELIGIBILITY

General Criteria

- Progressed within 1 year of graduation date from TEG Schools
- Applicable when progressed from TEG Schools (with IGCSE or equivalent) into Taylor's University/Taylor's College

Academic Criteria

- Meet minimum programme entry requirements

QUANTUM

- Up to RM5,000 tuition fee waiver

ALUMNI BURSARY (UNDERGRADUATE PROGRAMME)

PROGRAMME

All undergraduate programme except ACCA FIA, ACCA full-time & ACCA modular

ELIGIBILITY

General Criteria

- Progressed more than 1 year of graduation date from Taylor's University/Taylor's College/TEG Schools, and progress to higher level of study
- For students with IGCSE/Year 12 or equivalent from TEG

Academic Criteria

- Meet minimum programme entry requirements

QUANTUM

- Up to RM2,000 tuition fee waiver

SCHOLARSHIP

FREQUENTLY ASKED QUESTIONS

1

WHAT DOES TAYLOR'S SCHOLARSHIP COVER?

Taylor's Scholarship covers the Tuition Fee of the programme only for the standard duration. All other fees including repeat fees to be borne by students.

2

WHAT TYPES OF SCHOLARSHIPS ARE AVAILABLE?

We provide various scholarship opportunities based on criteria that include, but are not limited to, merit, talent, financial needs, and athletic achievement.

3

HOW DO I FIND DETAILED INFORMATION ON THE SCHOLARSHIPS?

You can explore the scholarships on our website. If you meet the minimum requirements for a scholarship, feel free to reach out to your appointed Counsellors to obtain the application form.

4

WHEN SHOULD I START APPLYING FOR SCHOLARSHIPS?

You can apply for scholarships during your first year, before the application deadline.

5

WHAT ARE THE ELIGIBILITY CRITERIA FOR SCHOLARSHIPS?

Eligibility criteria will vary depending on the type of scholarships applied. The information can be found on our scholarship website.

6

WHAT TYPE OF RESULTS SHOULD I USE FOR THE SCHOLARSHIP APPLICATION?

You may use forecast/trial/actual results to apply for the scholarships. For further details on how to use these results in your application, please refer to our scholarship eligibility criteria and Terms & Conditions.

7

DO I NEED TO MAINTAIN A CERTAIN CGPA/SCORE/GRADES TO CONTINUE MY SCHOLARSHIP?

Scholarship recipients are required to maintain satisfactory academic results as outlined by the minimum CGPA/score/grades specified in their scholarship offer letter.

8

ARE INTERNATIONAL STUDENTS ELIGIBLE FOR SCHOLARSHIPS?

Selected international applicants may apply should they meet the terms of the scholarship. Please refer to our Terms and Conditions for a detailed explanation of whether the requirements are met.

9

WILL I BE ABLE TO GET SPECIFIC FEEDBACK AT ANY STAGE OF THE APPLICATION PROCESS?

Unfortunately, we are unable to provide individual feedback to applicants as we receive a high volume of applications.

10

WHAT SHOULD I DO IF I'M AWARDED MULTIPLE SCHOLARSHIPS?

Should you receive any types of awards/discounts from any other bodies, these should be notified to us in writing. If found unreported, scholarships will be terminated with immediate effect.

UNDERGRADUATE SCHOLARSHIP TERMS & CONDITIONS

1. Scholarships listed are applicable for 2025 intakes only and are subject to availability on a first-come, first-serve basis.
 2. Scholarships are applicable for all Malaysian students that hold academic results from any accredited institution in Malaysia or selected overseas institutions with selected qualifications (e.g.: IGCSE, Cambridge A Level) and Taylor's Education Group (TEG) progression international students only. Clarification on accepted results may be obtained from the Scholarships Management through the student's appointed Counsellor.
 3. Scholarship application can only be made once for the particular level of study, at any one time and must be made at the point of enrolment. Late application or re-application will not be entertained.
 4. All 2025 scholarships are subject to the following eligibility criteria:
 - i. Studies conducted at Taylor's College/Taylor's University, Malaysia only;
 - ii. Registered full-time students at Taylor's College/Taylor's University;
 - iii. The programme and intake offered as stated in the Letter of Offer only; and
 - iv. Does not include a period of study at overseas partner institutions including student exchange, except where fee is payable to Taylor's College/Taylor's University (where applicable).
 5. All scholarships are only applicable for students progressing to a higher qualification from the current highest achieved qualification commencing from semester 1 without any credit transfer (except for transfers from Diploma/Advanced Diploma to Degree). Clarification on exceptions may be obtained from the Scholarships Management through the student's appointed Counsellor.
 6. Application for the scholarships may be submitted based on actual/forecast/trial results. For SPM students, only actual/trial results shall be considered eligible for the scholarship application, whereas, for IGCSE students, only actual/forecast results shall be considered for the same purpose.
 7. If forecast/trial results are used in the application, the actual results must meet the minimum programme entry requirements as stipulated by Taylor's College/Taylor's University and a copy must be furnished to Taylor's College/Taylor's University as soon as the results are out. Upon actual results being released, in the event the recipient fails to meet the minimum programme entry requirements, the recipient is required to leave the programme and the scholarship offer will be automatically revoked.
 8. All subjects taken during SPM will be considered except for:
 - i. 1119 (GCE-O)
 - ii. Principles of Accounting Dual Certification (LCCI)
 - iii. Ujian Pencapaian Bahasa Antarabangsa (UPBA).
 9. For IGCSE syllabus, KBSM grades will not be taken into consideration if the same subject has already been taken in IGCSE.
 10. For any other examination, all subjects are taken into consideration with the following exceptions:
 - i. Same/Similar subjects from different examination boards (e.g. Cambridge and Pearson) will be treated as one (1) subject for awarding purpose, where the highest grade applies;
 - ii. For language subjects, where two (2) subjects with varying level of proficiency are taken either from the same or different examination board, it will be treated as one (1) subject for awarding purposes, where the highest grade applies. Clarification on accepted subjects may be obtained from the Scholarships Management through your Counsellor.
 11. Applicants must be certain of their preferred intake and/or programme during the point of scholarship application. Should applicants defer or change to a different programme and/or intake of the same year or different year during the processing period, the application will be voided.
 12. Taylor's College/Taylor's University reserves the right to rescind the offer if documents contain false information. This includes applications without required attachments.
 13. Applicants are required to apply for the scholarship before the application deadlines. Any late or incomplete application will not be accepted. No appeals will be entertained.
 14. Scholarship application deadlines may be revised at the sole discretion of Taylor's College/Taylor's University without prior notice. Scholarship application deadlines can be found on the Taylor's College/Taylor's University website respectively.
 15. The scholarships are applicable to the programme and intake granted. Any changes to the intake and/or programme of study that result in the modification of programme title and/or duration of studies and/or intake commencement will result in immediate termination of the scholarship. For special consideration, the recipient shall correspond in writing immediately with the Scholarships Management to notify of the circumstance. Any approval for exceptions or special considerations is at the absolute discretion of the Scholarships Management and is not guaranteed. Where changes are made without prior approval, Taylor's College/Taylor's University reserves the right to withdraw the scholarship, and the recipient will be required to repay the total scholarship amount disbursed to him/her in full. All decisions made by Taylor's College/Taylor's University are final and no further appeals shall be entertained.
 16. Recipients are expected to provide any document(s) as requested by the Scholarships Management at any given time within the stipulated deadline communicated to facilitate any requirements deemed necessary by Taylor's College/Taylor's University. Failure to do so will result in the scholarship being revoked and the recipient to repay the scholarship amount disbursed to date in full.
 17. Recipients shall join the academic course at the given start date. Failure to do so will result in immediate termination of the scholarship.
 18. The scholarship is a fee waiver; it is not exchangeable for cash, is non-transferable and non-refundable and the manner in which the awarded amount is disbursed will be decided by the Scholarships Management. Any requests to amend the quantum disbursement will not be entertained.
 19. The scholarship only covers the tuition fees and for avoidance of doubt does not cover fees such as the International Student Annual Fee, EMGS Visa Application Fee, International Student Charge, Hospitalisation and Surgical Insurance Fee, EMGS Renewal Fee or any other Visa-related Fee.
 20. The scholarship only covers subjects enrolled for the first time (first attempt) in the letter of offer. Retake of module or repeat of subject will not be covered by the scholarship.
 21. All fees should be paid by the stipulated deadline, refusal to do so either when awaiting the scholarship outcome announcement and/or throughout the duration of study will be subjected to terms of the institution policy which includes and is not limited to barring from classes and may result in the scholarship application being disqualified/scholarship being terminated and full fees being charged to the applicant/recipient.
 22. Recipients are entitled to one (1) type of scholarship/bursary/award/waiver/discount at any one time including sponsorship from other external institutions/bodies. Recipients shall inform the Scholarships Management of any other scholarships or sponsorships currently held or awarded at a later date. For scholarship recipients, this disbursement will cease in the event recipients accept any external scholarship. The one with the highest quantum will automatically apply.
 23. If the scholarship offer is not accepted by the given deadline in the letter of offer, it will be automatically withdrawn and voided. No appeals will be entertained.
 24. By accepting this offer, recipients understand and accept the responsibility of being an exemplary student ambassador for Taylor's College/Taylor's University. Recipients must recognise that his/her behaviour and general conduct must, at all times, be above reproach and comply with all existing rules, regulations, requirements and policies of Taylor's College/Taylor's University. Recipients should not be involved, engaged in, or participate in any political, illegal or unlawful activity as a recipient of the scholarship whether within or outside the University premises. Failure to comply will result in immediate termination of scholarship and possible suspension in line with Institution policy.
 25. Recipients agree to act in an ambassadorial capacity, to provide student profiles or testimonials, interviews, advertisements, photographs, or any other publicity-related activities if requested, and to attend scholarship or recruitment events as required for Taylor's College/Taylor's University.
 26. Recipients are required to maintain satisfactory academic results as outlined by the minimum CGPA/score/grades specified in their scholarship offer letter throughout the standard programme duration. Failure to do so may result in the termination of the scholarship by Taylor's College/Taylor's University at the discretion of the Scholarships Management, taking into consideration due process as per the Scholarship policy.
 27. By accepting this award, recipients are expected to join the Scholar's Club and attend any Scholar's Club activities/events organised by the Scholarships Management and Scholar's Committee during the duration of their scholarship and attendance is a requirement under this scholarship.
 28. Upon accepting this scholarship, recipients are deemed to have accepted all terms and conditions stipulated here.
 29. Recipients also agree to indemnify and hold Taylor's College/Taylor's University harmless of and from any and all demands, claims, liabilities or actions of any kind whatsoever during their period of study at Taylor's College/Taylor's University.
 30. In the event the recipient withdraws from the programme, is suspended or terminated by Taylor's College/Taylor's University at any point of time before the completion of the programme, the scholarship shall be automatically terminated. However, should the recipient withdraw from the programme due to medical reasons, his/her scholarship may be retained, subject to the absolute discretion of the Scholarships Management.
 31. Taylor's College/Taylor's University, will be entitled to terminate the scholarship at any time, by immediate notice to the recipient in writing, in the event of:
 - i. misconduct, whether in connection with his/her study or otherwise;
 - ii. failure to make such progress in his/her study as is considered satisfactory;
 - iii. circumstances, such as illness, arising which, with the university's agreement, would render it impossible for the recipient to complete his/her scholarship satisfactorily or prevent the purpose of the scholarship from being fulfilled;
 - iv. dismissal, for any reason, from the recipient's host university (if on student exchange programme);
 - v. breach of any local Malaysian law and practices;
 - vi. conviction of bribery, in line with the Malaysian Anti-Corruption Act, the current scholarship will be rescinded, and the recipient will be banned from applying for any Taylor's financial aid and discounts for a period of up to five years;
 - vii. failure to comply with the conditions of his/her visa (if international student); and
 - viii. the discovery that the recipient has submitted fraudulent documentation.
 32. In the event of such termination, Taylor's College/Taylor's University shall have no further obligation to the recipient, and the recipient shall be bound to repay the amount that has been paid/waived to him/her under the scholarship, unless:
 - i. the termination is a result of his/her ill health and this has been certified by a registered medical practitioner; and
 - ii. Taylor's College/Taylor's University has exercised its discretion to exempt the recipient from this condition.
 33. Any breach of the scholarship condition(s) is treated seriously and if the recipient believes to have breached a condition whether intentionally or unintentionally, the recipient should contact the Scholarships Management immediately to discuss the situation. Recipients are urged to take prompt action to resolve any misunderstanding that may arise as a result of the breach, accidental or otherwise.
 34. All decisions made by Taylor's College/Taylor's University are final and no further appeals shall be entertained.
 35. Taylor's College/Taylor's University has a range of social media platforms for scholars and alumni to interact with. We look forward to receiving recipients' comments and participation in discussions, and we encourage open, lively debate. However, we do request that our scholars, fellows, and alumni adhere to certain good practices and conventions of polite and constructive discourse.
 36. Recipients agree to be contacted by Taylor's College/Taylor's University after graduation to be involved in interviews, advertisements, photography or other publicity-related activities for marketing purposes.
 37. The terms and conditions of scholarships may be modified and amended from time to time as deemed appropriate by Taylor's College/Taylor's University and the current version can be found on the Taylor's College/Taylor's University website.
 38. All information including personal data provided in the programme and scholarship application may be used by or on behalf of Taylor's College/Taylor's University in the following manner and is not limited to:
 - i. processing of scholarship application, collection of feedback, communicate details of events, academic programmes and marketing information, and for any other purposes as required by Taylor's College/Taylor's University; and
 - ii. periodical audit by Taylor's College/Taylor's University with regards to any information provided should the scholarship be administered, which includes and is not limited to grade reviews, semester status, and utilisation of data for institution needs.
- All data collected will be handled in strict accordance with the PDPA guidelines as per organisation policy.

AWARDS AND BURSARIES

TERMS & CONDITIONS

1. Awards listed are applicable for 2025 intakes only and are subject to availability on a first-come, first-serve basis.
2. Awards are applicable for all students that hold recognised academic results from accredited institutions in Malaysia. Malaysians from selected overseas institutions with selected qualifications (e.g. IGCSE, Cambridge A Level) may be considered. Clarification on accepted results can be obtained from the Scholarships Management through the student's appointed Counsellor.
3. All 2025 awards are subject to the following eligibility criteria:
 - i. Studies conducted at Taylor's College/Taylor's University, Malaysia only;
 - ii. Registered full-time students at Taylor's College/Taylor's University;
 - iii. The programme and intake offered as stated in the Letter of Offer only; and
 - iv. Does not include a period of study at overseas partner institutions including student exchange, except where fee is payable to Taylor's College/Taylor's University (where applicable).
4. Application for the Award may be submitted based on actual/forecast/trial results. For SPM students, only actual/trial results shall be considered eligible for the Award application, whereas, for IGCSE students, only actual/forecast results shall be considered for the same purpose. The latest available results will be considered at the point of processing.
5. If forecast/trial results are used in the application, the actual results must meet the minimum programme entry requirements as stipulated by Taylor's College/Taylor's University and a copy must be furnished to Taylor's College/Taylor's University as soon as the results are out. Upon actual results being released, in the event the recipient fails to meet the minimum programme entry requirements, the recipient is required to leave the programme and the scholarship offer will be automatically revoked.
6. All awards are only applicable for students progressing to a higher qualification from the current highest achieved qualification commencing from semester 1 without any credit transfer (except for transfers from Diploma/Advanced Diploma to Degree). Clarification on exceptions may be obtained from the Scholarships Management through the student's appointed Counsellor.
7. Award application must be done before the intake closing date. An exception is provided to students who receive their results after the intake closing date, whereby award application or upgrade may be done within 10 working days from the results release date, which may include online results, provisional results, or any other form of formal/recognised confirmation of results. Application and/or upgrade form must be filled and submitted with the results copy attached to Campus Central at campuscentral@taylors.edu.my before the stipulated deadline. The application and/or upgrade form may be obtained from the student's appointed Counsellor or from Campus Central.
8. All award applications and upgrades can only be done once.
9. Should the documents provided not be sufficient at the point of processing, Scholarships Management reserves the right to request the necessary additional supporting documents which must be provided within the stipulated deadline for further review. Failure to do so will result in the Award application being null and void.
10. The award shall be in the form of a tuition fee waiver; it is not exchangeable for cash, is non-transferable and non-refundable and the manner in which the awarded amount is disbursed may vary by programme and will be decided by the Scholarships Management. Any request to amend the quantum disbursement will not be entertained.
11. The award is applicable in long semesters only and is limited to the maximum deduction subject to quantum awarded. For avoidance of doubt, in long semesters where the tuition fees are lower than the awarded quantum, deductions made shall be equivalent to the semester's tuition fees only.
12. All subjects taken during SPM will be considered except for:
 - i. 1119 (GCE-O).
 - ii. Principles of Accounting Dual Certification (LCCI).
 - iii. Ujian Pencapaian Bahasa Antarabangsa (UPBA).
13. For IGCSE syllabus, KBSM grades will not be taken into consideration if the same subject has already been taken in IGCSE.
14. For any other examination, all subjects are taken into consideration with the following exceptions:
 - i. Same/Similar subjects from different examination boards (e.g. Cambridge and Pearson) will be treated as one (1) subject for awarding purpose, where the highest grade applies;
 - ii. For language subjects, where two (2) subjects with varying levels of proficiency are taken either from the same or different examination boards, it will be treated as one (1) subject for awarding purposes, where the highest grade applies. Clarification on accepted subjects may be obtained from the Scholarships Management through the student's appointed Counsellor.
15. Recipients must meet the minimum programme entry requirements and the award requirements as stipulated by Taylor's College/Taylor's University.
16. The awards are applicable to the programme and intake granted. Any changes to the intake and/or programme of study that result in the modification of programme title and/or duration of studies and/or intake commencement will result in immediate termination of the award. For special consideration, the recipient shall correspond in writing immediately with the Scholarships Management to notify of the circumstance. Any approval for exceptions or special considerations is at the absolute discretion of the Scholarships Management and is not guaranteed. Where changes are made without prior approval, Taylor's College/Taylor's University reserves the right to withdraw the award, and the recipient will be required to repay the total award amount disbursed to him/her in full. All decisions made by Taylor's College/Taylor's University are final and no further appeals shall be entertained.
17. The award only covers the tuition fees and for avoidance of doubt does not cover fees such as the International Student Annual Fee, EMGS Visa Application Fee, International Student Charge, Hospitalisation and Surgical Insurance Fee, EMGS Renewal Fee or any other Visa-related Fee.
18. The award only covers subjects enrolled for the first time (first attempt) in the letter of offer. Retake of module or repeat of subject will not be covered by the award.
19. All fees should be paid by the stipulated deadline. Refusal to do so either when awaiting the award outcome announcement and/or throughout the duration of study will be subjected to terms of the institution policy which includes and is not limited to barring from classes and may result in the award application being disqualified/award being terminated and full fees being charged to the applicant/recipient.
20. Recipients are encouraged to contact Scholarships Management with any enquiry regarding deductions prior to remitting payment for the respective semester should there be any. All requests submitted after payment or upon graduation will not be entertained.
21. Recipients are entitled to one (1) type of scholarship/bursary/award/waiver/discount at any one time including sponsorship from other external institutions/bodies. Recipients shall inform the Scholarships Management of any other scholarships or sponsorships currently held or awarded at a later date. The one with the highest quantum will automatically apply.
22. Upon accepting this award, the recipient is deemed to have accepted all terms & conditions stipulated here.
23. By accepting this award, the recipient agrees to indemnify and hold Taylor's College/Taylor's University harmless of and from any and all demands, claims, liabilities or actions of any kind whatsoever.
24. All awards offered by Taylor's College/Taylor's University to any students are at the absolute discretion of Taylor's College/Taylor's University and no further appeals shall be entertained.
25. Taylor's College/Taylor's University reserves the right to rescind the offer if documents contain false information. This includes applications without required attachment(s).
26. Any late or incomplete application will not be accepted.
27. The terms and conditions of awards may be modified and amended from time to time as deemed appropriate by Taylor's College/Taylor's University and the current version can be found on the Taylor's College/Taylor's University website.
28. All information including personal data provided in the programme and award application may be used by or on behalf of Taylor's College/Taylor's University in the following manner and is not limited to:
 - i. processing of award application, collection of feedback, communicating details of events, academic programmes and marketing information, and for any other purposes as required by Taylor's College/Taylor's University; and
 - ii. periodical audit by Taylor's College/Taylor's University with regards to any information provided should the award be administered, which includes and is not limited to grade reviews, semester status, and utilisation of data for institution needs.

All data collected will be handled in strict accordance with the PDPA guidelines as per organisation policy.

For More Info

SCAN HERE



TAYLOR'S

TAYLOR'S COLLEGE, LAKESIDE CAMPUS
(682946-T)

Block E, East Wing, Taylor's Lakeside Campus,
No.1, Jalan Taylor's, 47500 Subang Jaya,
Selangor Darul Ehsan, Malaysia.
Tel : +603 - 5629 5000 Fax : +603 - 5629 5001
Email : applications@taylors.edu.my
college.taylors.edu.my

TAYLOR'S UNIVERSITY SDN. BHD.
198601000495 (149634-D) DU023 (B)

No.1, Jalan Taylor's, 47500 Subang Jaya,
Selangor Darul Ehsan, Malaysia.
Tel : +603-5629 5000
Fax : +603-5629 5001
Email : applications@taylors.edu.my
university.taylors.edu.my

This publication contains information, which is current as of March 2025. Changes in circumstances after this date may impact upon the accuracy or timeliness of the information. Taylor's College/ Taylor's University does its best to ensure that the information contained herein is accurate, but reserves the right to change any information described in this brochure without notice. Readers are responsible for verifying information that pertains to them by contacting the college/ university.



**TAYLOR'S
UNIVERSITY**

Wisdom · Integrity · Excellence

Rise With The Best™

Where our community is our strength

Taylor's University Sdn. Bhd. (Co. No. 149634-D)
JPT/BPP(D)1000-701/502(16) DU023 (B)

No. 1, Jalan Taylor's, 47500 Subang Jaya,
Selangor Darul Ehsan, Malaysia.

Tel : +603-5629 5000

Fax : +603-5629 5001

Email : applications@taylors.edu.my

Website : university.taylors.edu.my

Taylor's Education Counselling Centres

• Penang office	Tel: +604-899 9396/ +604-892 0396	Mobile: +6012-632 9396
• Johor office	Tel: +607-351 3692 / 3694	Mobile: +6017-302 8188
• Sabah office	Tel: +6088-338898	Mobile: +6012-605 0802
• Sarawak office	Tel: +6082-384998	Mobile: +6016-760 7639
• Melaka Region	Mobile: +6012-655 0803	
• East Coast Region	Mobile: +6012-878 1907	

This publication contains information, which is current as of January 2024. Changes in circumstances after this date may impact upon the accuracy or timeliness of the information. Taylor's University does its best to ensure that the information contained herein is accurate, but reserves the right to change any information described in this prospectus without notice. Readers are responsible for verifying information that pertains to them by contacting the university.